

⚠ DANGER
 Hazardous voltage.
 Will cause death or
 serious injury.
 Keep out.
 Qualified personnel only.
 Disconnect and lock off all
 power before working on this
 equipment.

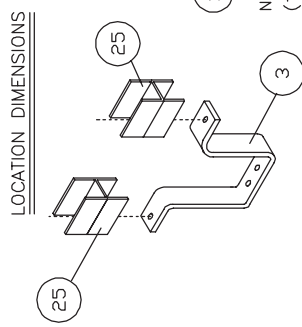

TORQUE VALUES

- 12 10 50 in.-lbs. AL.
- 72 in.-lbs. CU.

NOTES

- FOR PROVISIONS - FILL BLANK SPACE WITH ITEMS #15 & 25
- F6-FRAME BRANCH BREAKER 70-250 AMPERE DOUBLE MOUNTING

4	1C-267A	3-8-00
3	1A-280	1-30-90
2	1A042	1-3-88

Unless otherwise specified dimensions are in inches and are non-cumulative and are as follows unless specified otherwise.		Confidential - Property of Siemens Industry, Inc. Building Technologies Division	
Date	1A036 8-25-88	F6 FRAME MOUNTING SPP (SHALLOW) BRANCH BUS	
C.N.	1A045 10-5-88	Rev. 15-B-2014-00	
Dwn	DB	Date	3-8-00
Chk	RHR	Date	3-8-00
Apvd	RHR	Date	3-8-00
Scale	NONE	Sheet	1 of 1

Apvd PM	ITEM	DESCRIPTION	PC. NO.	QTY.
11-30-90	1	F6 PH. A&C FRONT BRANCH BUS	12-B-4002-02	2
	2	F6 PH. A&C REAR BRANCH BUS	12-B-4003-02	2
	3	F6 PH. B BRANCH BUS	12-B-4004-02	1
	4			
	5	F6 MOUNTING BRACKET	15-B-3018-01	2
	6	5' F6 COVER PLATE	12-6028-01	1
	7	CIRCUIT ID CARD	11-7505-01	2
	8	CARD HOLDER	11-7506-01	2
	9	14-20 X 3/8 SHWHSW	11-1553-02	6
	10	STRAP-BUS HARDWARE KIT	11-B-2023-05	1
	11			
	12	1/4-20 X 1 SHWHSW	11-1553-09	6
	13	1/4-20 X 4 SRHMS	11-1542-19	4
	14			
	15	BLANK FILLER	12-5531-10	2
	16	10-24 X 5/8 RHSNB	11-1630-02	4
	17	10-24 LOCK NUT	11-1821-02	4
	18	NEUTRAL LUG ASSEMBLY	12-B-2105-05	2
	19			
	20			
	21			
	22			
	23			
	24			
	25	PH. B BARRIER (FOR PROVISIONS)	11-7548-02	4
	26			
	27			
	28	INSTRUCTION SHEET	31-1202-01	1
	29	CARTON LABEL	15-A-1027-01	1
	30	CARTON	48001056	1
	31			
	32			
	33			
	34			
	35			

FOR I-T-E TYPE BREAKERS: FJ6, F6, HF6, FXD6, FD6, HFD6 70-250 AMPERES
 FOR (SHALLOW) PANELBOARDS
 MERCHANDISE KIT NO. SF6

Confidential - property of Siemens Industry, Inc. Building Technologies Division	F6-FRAME MOUNTING S4, COPPER BRANCH BUS	15-B-2014-03	7
	Title	Sht. 1	Of 1
			Rev.

FOR USE WITH FXD6, FD6 AND HFD6 FRAME BREAKERS
 MOUNTED IN SPP/FPP/S4/F1/P4 PANELBOARDS (SHALLOW DEPTH).