

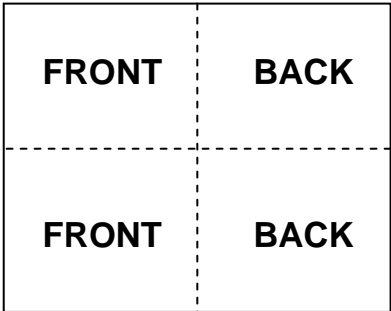

REVISIONS			
REV	DESCRIPTION	DATE	APPROVED
0P	Initial Release	6/21/2004	KMA
1P	Pc. No. was A00; Modified bar code & Illustrations	6/21/2005	KMA/MRE

Notes:

- Use black text printing on 8 ½ X 11 White Card Stock - 90 lb. as follows:
 - Print to front and back of each page
 - Cut to produce qty (4) 4 ¼ X 5 ½ cards from each sheet
 - Do not fold
- All Instruction Sheets are to be individually printed. **DO NOT USE COPY MACHINE.**



CONFIDENTIAL- PROPERTY OF Siemens Energy & Automation, Inc.									
UNLESS OTHERWISE SPECIFIED DIMENSIONS ARE IN INCHES DO NOT SCALE DRAWING TOLERANCES: .XX ± .XXX ± ANGULAR ±			Siemens Energy & Automation, Inc.						
			LUG KIT, NGG 35-125A Instruction Sheet						
DWN	KMA	DATE	1/5/04	SIZE	FSCM NO.	DWG NO.	806635	REV.	1P
CHK	KMA	DATE	1/5/04	A					
APVD	KMA	DATE	1/5/04	SCALE	1 to 1	ACAD FILE:		SHEET	1 OF 2

IB 8-16-95



 Danger	 Peligro	 Danger
Hazardous Voltage. Will cause death or serious injury. Turn off and lock out all power supplying this device before working on this device. Replace all covers before power supplying this device is turned on.	Tensión peligrosa. Puede causar la muerte o lesiones graves. Desenergice totalmente antes de instalar o darle servicio. Reemplace todas las barreras y cubiertas antes de energizar el interruptor.	Tension dangereuse. Danger de mort ou risque de blessures graves. Couper l'alimentation de l'appareil et barrer avant de travailler. Remplacez tous les couverts avant que l'alimentation de pouvoir soit alimenté.

35 - 125 Amp

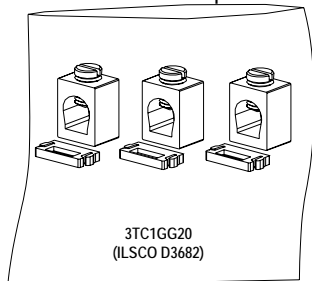

3TC1GG20
(ILSCO D3682)

Lug Kit
[Juego de Bornes]

For Use With Type NGG
[Para Usar Con Caja Tipo NGG]

These connectors may only be used with specific equipment for which it has been found acceptable.

[Estos conectores solamente pueden ser utilizados con el equipo específico para el cual se ha encontrado aceptable]

Qty. 1	Cat. No. 3TC1GG20	DC No. 7 83643 51536 9
------------------	-----------------------------	----------------------------------

Siemens Energy & Automation, Inc.
Bellefontaine, Ohio 43311 U.S.A.

Technical Support 1-800-964-4114
Pc. No. 806635A01 Rev. No. 1P

 Danger	 Peligro	 Danger
Hazardous Voltage. Will cause death or serious injury. Turn off and lock out all power supplying this device before working on this device. Replace all covers before power supplying this device is turned on.	Tensión peligrosa. Puede causar la muerte o lesiones graves. Desenergice totalmente antes de instalar o darle servicio. Reemplace todas las barreras y cubiertas antes de energizar el interruptor.	Tension dangereuse. Danger de mort ou risque de blessures graves. Couper l'alimentation de l'appareil et barrer avant de travailler. Remplacez tous les couverts avant que l'alimentation de pouvoir soit alimenté.

35 - 125 Amp

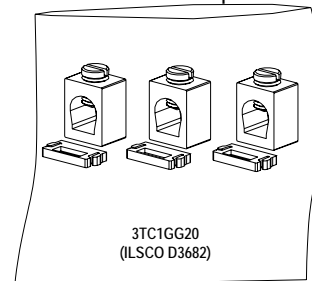

3TC1GG20
(ILSCO D3682)

Lug Kit
[Juego de Bornes]

For Use With Type NGG
[Para Usar Con Caja Tipo NGG]

These connectors may only be used with specific equipment for which it has been found acceptable.

[Estos conectores solamente pueden ser utilizados con el equipo específico para el cual se ha encontrado aceptable]

Qty. 1	Cat. No. 3TC1GG20	DC No. 7 83643 51536 9
------------------	-----------------------------	----------------------------------

Siemens Energy & Automation, Inc.
Bellefontaine, Ohio 43311 U.S.A.

Technical Support 1-800-964-4114
Pc. No. 806635A01 Rev. No. 1P

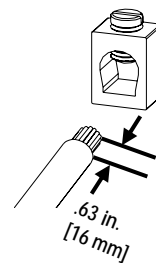

3TC1GG20
Cu / Al - 75 C

8 AWG - 40 lb. in. [4.5 N-m]
6 - 4 AWG - 45 lb. in. [5.1 N-m]
3 - 2/0 AWG - 55 lb. in. [6.2 N-m]

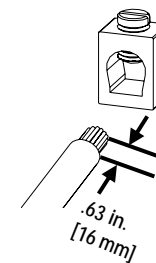
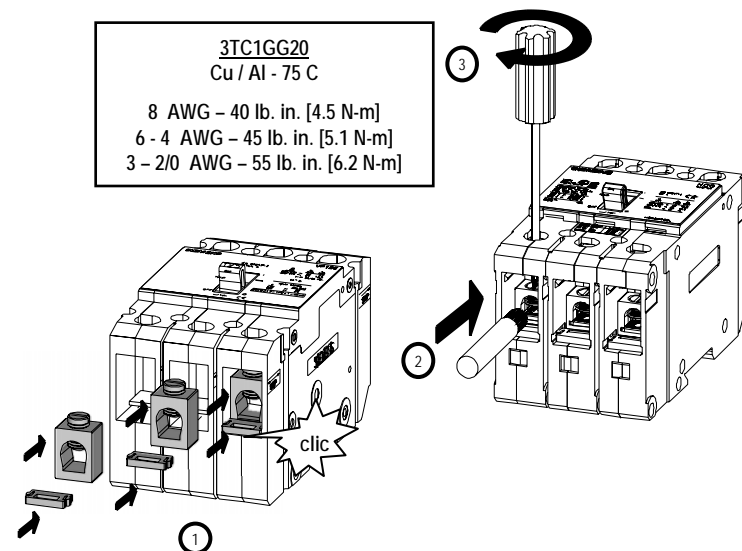

3TC1GG20
Cu / Al - 75 C

8 AWG - 40 lb. in. [4.5 N-m]
6 - 4 AWG - 45 lb. in. [5.1 N-m]
3 - 2/0 AWG - 55 lb. in. [6.2 N-m]

