



**Stecksocketrelais**  
**Plug-in relay**  
**Relais embrochable**  
**Relé enchufable**  
**Relè su zoccolo ad innesto**  
**Relê de base de encaixe**

**3TX7014**  
**3TX7015**

CE EN 60947, IEC/CEI 60947

**Betriebsanleitung**    **Operating Instructions**    **Instructions de service**    **Bestell-Nr./Order No.: 3ZX1012-0TX70-2AA1**  
**Instructivo**    **Istruzioni di servizio**    **Instruções de Serviço**

Vor der Installation, dem Betrieb oder der Wartung des Geräts muss diese Anleitung gelesen und verstanden werden.  
 Read and understand these instructions before installing, operating, or maintaining the equipment.  
 Ne pas installer, utiliser ou entretenir cet équipement avant d'avoir lu et assimilé ce instructions.  
 Leer y comprender este instructivo antes de la instalación, operación o mantenimiento del equipo.  
 Leggere con attenzione questi istruzioni prima di installare, utilizzare o eseguire manutenzione su questa apparecchiatura.  
 Ler e compreender este manual antes da instalação, operação ou manutenção do equipamento.

 	<p><b>⚠ GEFAHR</b></p> <p><b>Gefährliche Spannung. Lebensgefahr oder Gefahr schwerer Verletzung. Vor Beginn der Arbeiten Anlage und Gerät spannungsfrei schalten.</b></p>	<p><b>⚠ DANGER</b></p> <p><b>Hazardous voltage. Will cause death or serious injury. Disconnect power before working on equipment.</b></p>	<p><b>⚠ DANGER</b></p> <p><b>Tension dangereuse. Danger de mort ou risque de blessures graves. Mettre hors tension avant d'intervenir sur l'appareil.</b></p>
	<p><b>⚠ PELIGRO</b></p> <p><b>Tensión peligrosa. Puede causar la muerte o lesiones graves. Desconectar la alimentación eléctrica antes de trabajar en el equipo.</b></p>	<p><b>⚠ PERICOLO</b></p> <p><b>Tensione pericolosa. Può provocare morte o lesioni gravi. Scollegare l'alimentazione prima di eseguire eventuali interventi all'equipaggiamento.</b></p>	<p><b>⚠ PERIGO</b></p> <p><b>Tensão perigosa. Perigo de morte ou ferimentos graves. Desligue a corrente antes de trabalhar no equipamento.</b></p>

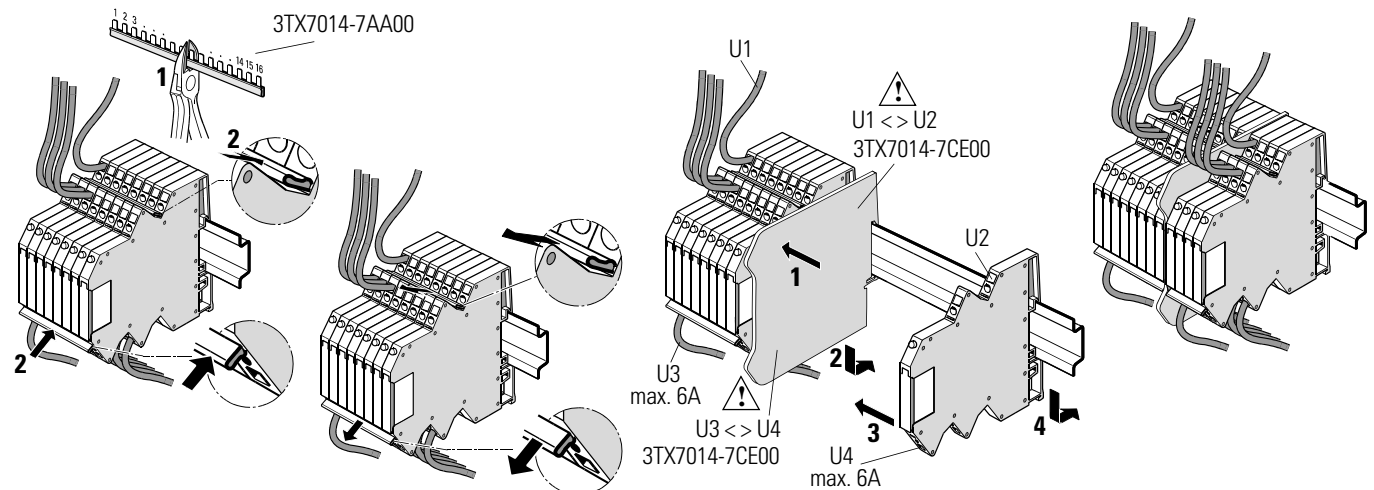
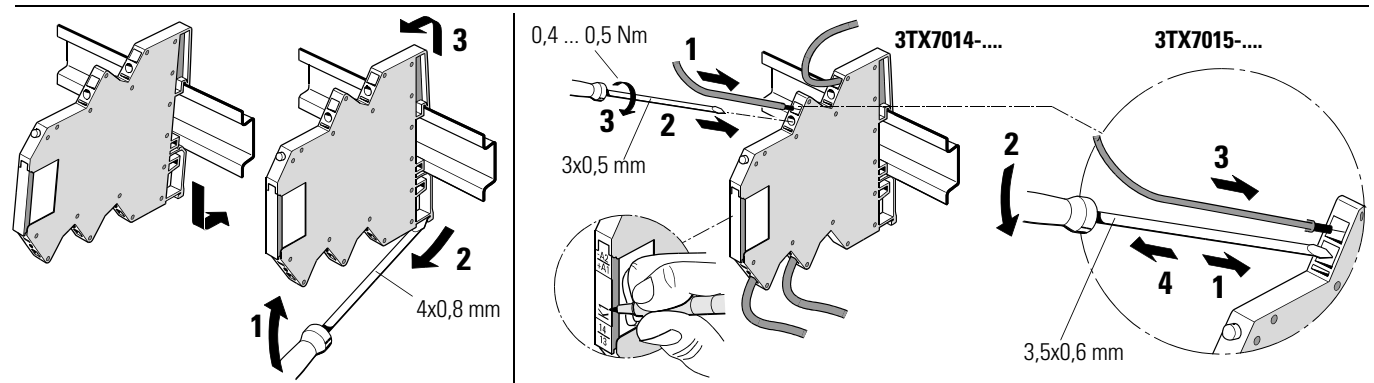

Eine sichere Gerätefunktion ist nur mit zertifizierten Komponenten gewährleistet.  
 Reliable functioning of the equipment is only ensured with certified components.  
 Le fonctionnement sûr de l'appareil n'est garanti qu'avec des composants certifiés.  
 El funcionamiento seguro del aparato sólo está garantizado con componentes certificados.  
 Il funzionamento sicuro dell'apparechiatura viene garantito soltanto con componenti certificati.  
 O funcionamento seguro do aparelho apenas pode ser garantido se forem utilizados os componentes certificados.

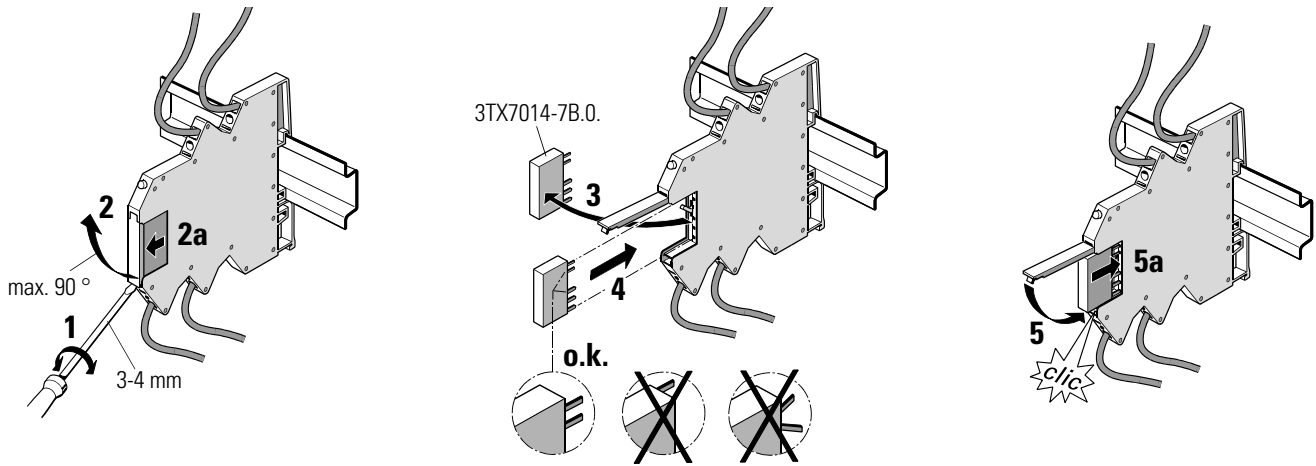

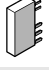
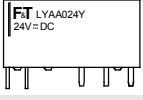
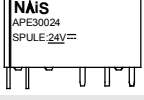
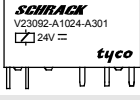

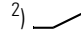
3TX7014-.. 3TX7015-..	(+A1/(-)A2	NO (13/14) CO (11/12/14)	3TX7014-..			
				FTR-LY..	APE..	V23092-..
..1AM00 <sup>1)</sup>	DC 24 V	NO	..7BM00 <sup>1)</sup>	 FTR L YAA024Y 24V=DC	 NAIS APE30024 SPULE 24V=	 SCHIRACK V23092-A1024-A301 24V= tyco
..1BM00 <sup>1)</sup>	DC 24 V	CO	..7BM00 <sup>1)</sup>	..CA024Y	..30024	..A1024-A301
..1BB00 <sup>1)</sup>	AC/DC 24 V	CO	..7BQ00 <sup>1)</sup>	..CA012Y	..30012	..A1012-A301
..1BE00 <sup>1)</sup>	AC/DC 115 V	CO	..7BP00 <sup>1)</sup>	—	..30060	..A1060-A301
..1BF00 <sup>1)</sup>	AC/DC 230 V	CO	..7BP00 <sup>1)</sup>	—	..30060	..A1060-A301
..1BM02 <sup>2)</sup>	DC 24 V	CO	..7BM02 <sup>2)</sup>	..CA024V	..30124	..A1024-A201
..1BB02 <sup>2)</sup>	AC/DC 24 V	CO	..7BQ02 <sup>2)</sup>	..CA012V	..30112	..A1012-A201
..1BE02 <sup>2)</sup>	AC/DC 115 V	CO	..7BP02 <sup>2)</sup>	—	..30160	..A1060-A201
..1BF02 <sup>2)</sup>	AC/DC 230 V	CO	..7BP02 <sup>2)</sup>	—	..30160	..A1060-A201

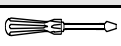
<sup>1)</sup>  = AgSnO      <sup>2)</sup>  = AgSnO + Au

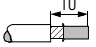
	3TX7014	3TX7015
 3x0,5 mm	0,4 ... 0,5 Nm 3,5 ... 4,5 lb · in	 3,5x0,6 mm
 10	0,5 ... 2,5 mm <sup>2</sup>	0,5 ... 2,5 mm <sup>2</sup>
 10	0,5 ... 2,5 mm <sup>2</sup>	0,5 ... 2,5 mm <sup>2</sup>
 10	0,5 ... 1,5 mm <sup>2</sup>	0,5 ... 1,5 mm <sup>2</sup>
AWG	28 to 14	28 to 14

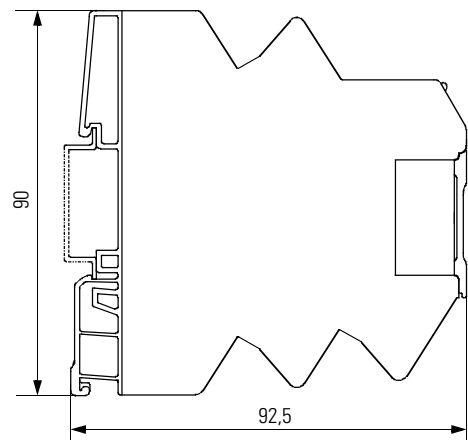
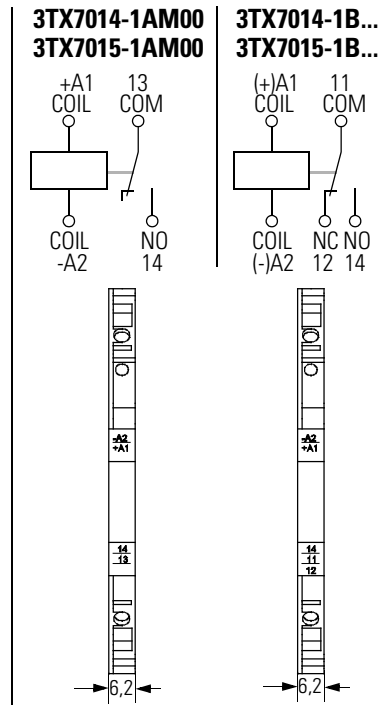

**Technical Assistance:** Telephone: +49 (0) 911-895-5900 (8<sup>00</sup> - 17<sup>00</sup> CET)  
E-mail: [technical-assistance@siemens.com](mailto:technical-assistance@siemens.com)  
Internet: [www.siemens.de/lowvoltage/technical-assistance](http://www.siemens.de/lowvoltage/technical-assistance)

Fax: +49 (0) 911-895-5907

**Technical Support:** Telephone: +49 (0) 180 50 50 222

Technische Änderungen vorbehalten. Zum späteren Gebrauch aufbewahren!  
Subject to change without prior notice. Store for use at a later date.  
© Siemens AG 2004

**Bestell-Nr./Order No.:** 3ZX1012-0TX70-2AA1  
Printed in the Federal Republic of Germany