

SIEMENS

SEBP4V1

Installation Instructions for
Service Entrance Barrier Kit for
JD or LD or MG Main Breaker
in P4 or P5 Panelboards



This instruction sheet is to support the field installation of a Service Entrance Barrier Kit in a Siemens P4 or P5 Panelboard. Kit SEBP4V1 is for a Horizontally-mounted JD, LD or MG Main Breaker in a P4 or P5 Panelboard. This covers both single and three phase panels, either top or bottom fed units.

1. Lock off ALL power supplying this equipment before working on it.
2. Remove the panelboard front cover and deadfront.
3. Identify the Service Terminal End of the Service Main this will be added to.
4. Place the base of the Barrier Support Bracket (Item 1) on the Strap Support Barrier, aligning the pair of bracket holes to the open pair of barrier holes closest to the Base Rail.
5. Drive the 1/4"-20 screws (Item 2) through the properly aligned holes of the Barrier Support Bracket (Item 1) and into the Strap Support Barrier. Tighten both screws (Item 2) to 20 lb-in.
6. Next position the Barrier Assembly (Item 3) onto the Barrier Support Bracket (Item 1) such that the smaller pair of holes on the barrier top align with the hole on each end of the Barrier Support Bracket. (NOTE: Barrier should cover previously exposed lugs on the Service Terminal End of the breaker.)
7. Drive the #10-32 screws (Item 4) through the properly aligned holes of the barrier and into the Barrier Support Bracket holes. Tighten both screws (Item 4) to 20 lb-in.
8. **Before energizing the panel**, ensure that ALL connections have been properly torqued, that the barrier is in place and secure, that the deadfront covers are installed and that all fillers are in place.

THIS KIT CONTAINS THE FOLLOWING ITEMS:		
ITEM	DESCRIPTION	QTY
1	Barrier Support Bracket	1
2	1/4"-20 x 1/2" SHWSW Screw	2
3	Barrier Assembly	1
4	#10-32 x 3/8" HWHSW Screw	2

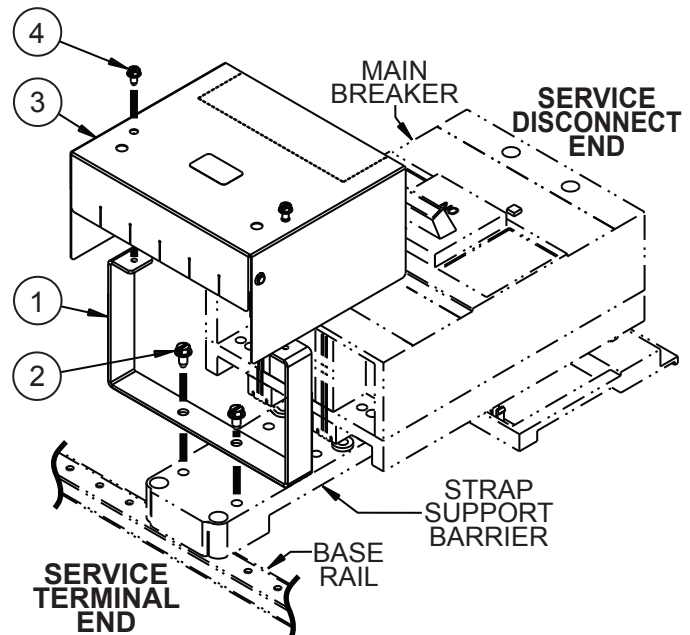
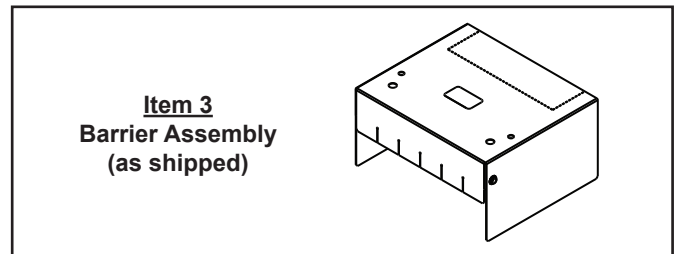

ASSEMBLY DETAILS

These instructions do not purport to cover all details or variations in equipment, or to provide for every possible contingency to be met in connection with installation, operation or maintenance. Should further information be desired or should particular problems arise, which are not covered sufficiently for the purchaser's purposes, the matter should be referred to the local Siemens sales office. The contents of this Instruction manual shall not become part of or modify any prior or existing agreement, commitment or relationship. The sales contract contains the entire obligation of Siemens. The warranty contained in the contract between the parties is the sole warranty of Siemens. Any statements contained herein do not create new warranties or modify the existing warranty.

Trademarks-Unless otherwise noted, all names identified by ® are registered trademarks of Siemens AG or Siemens Industry, Inc. The remaining trademarks in this publication may be trademarks whose use by third parties for their own purposes could violate the rights of the owner.