



SIEMENS

CATALOG NO. 3F3Y225ESTP1 SERIAL NO. SERIES H 225 kVA 60 Hz 3 PHASE 4.8 % IMP AT 170 °C		<p>VOLTS CONNECT</p> <table border="1"> <tr><td>504</td><td>1</td></tr> <tr><td>492</td><td>2</td></tr> <tr><td>480</td><td>3</td></tr> <tr><td>468</td><td>4</td></tr> <tr><td>456</td><td>5</td></tr> <tr><td>444</td><td>6</td></tr> <tr><td>432</td><td>7</td></tr> </table>	504	1	492	2	480	3	468	4	456	5	444	6	432	7
504	1															
492	2															
480	3															
468	4															
456	5															
444	6															
432	7															
150 °C RISE °C AVG. AMBIENT 220 °C TEMP CLASS °C MAX. AMBIENT PRIMARY (H1 H2 H3) 480V V SECONDARY(X0 X1 X2 X3) 208Y/120V V																
WINDING MATERIAL AL ENCLOSURE TYPE NEMA-3R WEIGHT 1600 LBS ENERGY EFFICIENCY NEMA TP 1-2002																
SPACINGS BETWEEN ENCLOSURE AND ANY ADJACENT WALL SHALL BE A MINIMUM OF 6 INCHES ELECTROSTATIC SHIELD																
VERIFIED Energy Performance Certification Energetique VERIFIED		TYPE K DRY TYPE TRANSFORMER 77105 E112313 														
SUITABLE FOR INDOOR OR OUTDOOR LOCATIONS BEFORE HANDLING, INSTALLING AND OPERATING, SEE INSTRUCTION MANUAL NEMA Class ANN Dry Type Transformer Siemens Industry, Inc. Norcross, GA dsu0082e																

REVISION	DATE	BY	DATE	BY
		DRAWN	06/04/19	RB
		CHEK'D		
		VERIF'D		

Confidential - Property of
Siemens Industry, Inc.
 Building Technologies Division

CUSTOMER	
ORDER NO.	DWG. NO.
	3F3Y225ESTP1
SH 1 OF 2	

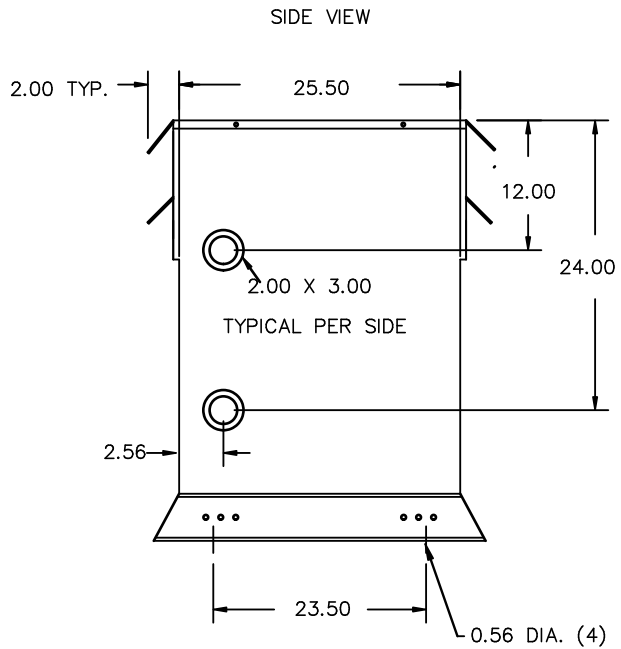
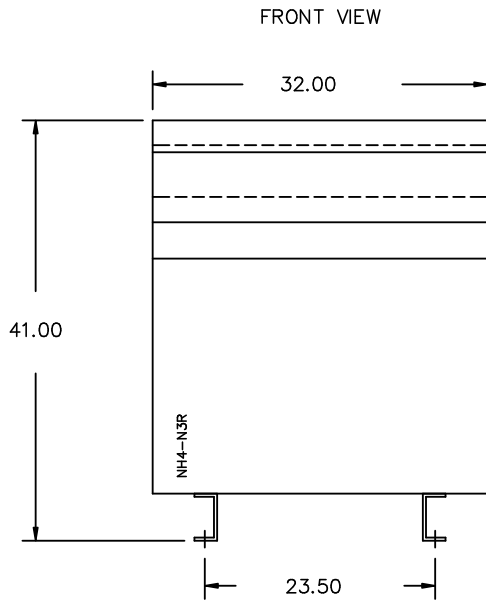

All Dimensions in inches

ENCLOSURE COLOR :ANSI 61 GREY – OUTDOOR

H.V.1. TERMINAL DETAIL

L.V.1. TERMINAL DETAIL

MECHANICAL TYPE LUGS INCLUDED
SUITABLE FOR 350MCM-6 CU/AL
CONDUCTORS
2 CONDUCTORS PER PHASE

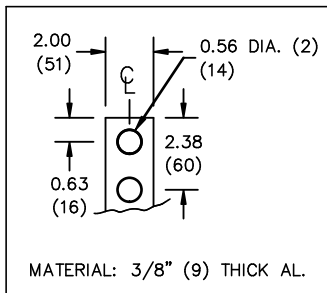

CUSTOMER NOTES:

- HV1 TERMINATED AT TOP FRONT
- LV1 TERMINATED AT COIL FACE

Confidential – Property of
Siemens Industry, Inc.
Building Technologies Division

REVISION	DATE	BY	DATE	BY
		DRAWN	06/04/19	RB
		CHEK'D		
		VERIF'D		

CUSTOMER	
ORDER NO.	DWG. NO. 3F3Y225ESTP1
SH 2 OF 2	

0.2 jwen 2010/03/10 13:47