

# SIEMENS



## Product Guide

# Enclosed Rotary Disconnect Switches

- 20-100A, Non-fusible
- Available in both Type 12 and 4X non-metallic enclosures
- Both screw and hinged cover designs available
- Listed and marked "suitable for use as motor disconnect" per NEC Section 430-109
- UL and CUL listed under File No. E191706 as Enclosed Rotary Controllers per UL508
- IEC 60947-3 rated and CE marked (enclosures are IP65 rated)
- UL listed for multiple line and load conductors per phase in 30-100A ratings
- HP rated through 50HP at 480 or 600V AC max
- Rotary handles are available in black, red and yellow and in pistol grip designs
- Optional auxiliary contact and ground lug kits available in 30-100A ratings

# Enclosed Rotary Disconnect Switches

## Ordering information

Ampere rating	Catalog number	Shipping wgt. <sup>1)</sup>	Horsepower ratings						
			120V AC		240V AC		480V AC		600V AC
			1-phase	1-phase	3-phase	1-phase	3-phase	3-phase	
<b>3-pole, non-fusible, Type 12 <sup>2)</sup> with screw cover and black rotary handle, 480V AC max <sup>3)</sup></b>									
20	HNF3020CJ <sup>4)</sup>	1	¾	2	5	5	10	—	
30	HNF3030CJ <sup>4)</sup>	2	2	3	7½	7½	15	20	
60	HNF3060CJ <sup>5)</sup>	4	3	10	15	20	40	50	
100	HNF3100CJ <sup>5)</sup>	5	5	15	25	30	50	—	
<b>3-pole, non-fusible, Type 12 <sup>2)</sup> with screw cover and red and yellow rotary handle, 480V AC max <sup>3)</sup></b>									
20	HNF3020CJE <sup>4)</sup>	1	¾	2	5	5	10	—	
30	HNF3030CJE <sup>4)</sup>	2	2	3	7½	7½	15	20	
60	HNF3060CJE <sup>5)</sup>	4	3	10	15	20	40	50	
100	HNF3100CJE <sup>5)</sup>	5	5	15	25	30	50	—	
<b>3-pole, non-fusible, Type 4, 4X <sup>6)</sup> with hinged door and black pistol grip rotary handle 480V AC Max <sup>3)</sup></b>									
30	HNF3030CX	4	2	3	7½	7½	15	20	
60	HNF3060CX	4	3	10	15	20	40	50	
100	HNF3100CX	5	5	15	25	30	50	—	

1) Carton quantity of (1). Shipping weight in pounds (lbs.).

2) Also rated Type 4/4X and UL/CUL approved for both indoor and outdoor use. No cover interlock provided.

3) 30 and 60A switches are also rated 600V AC.

4) Also UL approved as Type 13.

5) Also UL and CUL approved as Type 13.

6) UL approved for both indoor and outdoor use. Defeatable cover interlock provided.

## Enclosed disconnect switch dimensions (inches)

Catalog number	Figure Number	Dimensions			
		A	B	C	D
HNF3020CJ	1	4.92	2.95	3.94	5.44
HNF3020CJE		4.92	2.95	3.94	5.44
HNF3030CJ		6.89	4.92	3.94	5.44
HNF3030CJE		6.89	4.92	3.94	5.44
HNF3060CJ	1	9.46	6.31	4.77	6.27
HNF3060CJE		9.46	6.31	4.77	6.27
HNF3100CJ		11.77	7.87	5.20	6.70
HNF3100CJE		11.77	7.87	5.20	6.70
HNF3030CX	2	7.87	7.87	5.20	7.29
HNF3060CX		11.77	7.87	5.20	7.29
HNF3100CX		11.77	7.87	5.20	7.29

## Wire ranges 60/75°C Cu only

Ampere rating	Lug wire range
20	(1) #14 - #10 AWG Solid (1) #14 - #10 AWG Stranded
30	(1) #14 - #10 AWG Solid (1) #14 - #4 AWG Stranded Up to (4) #12 AWG Solid Up to (3) #12 AWG Stranded Up to (6) #14 AWG Stranded Up to (4) #14 AWG Stranded with (1) #10 AWG Stranded
60 & 100	(1) #14 - #10 AWG Solid (1) #14 - #1 AWG Stranded (2) #6 AWG Stranded Up to (3) #8 AWG Stranded Up to (6) #10 AWG Stranded Up to (6) #12 AWG Solid

Figure 1

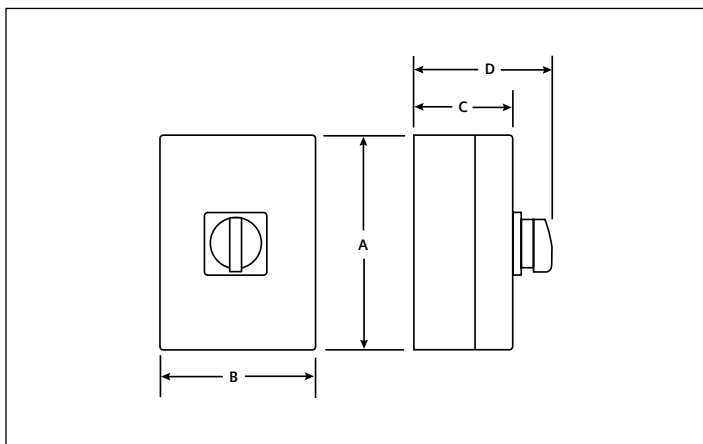
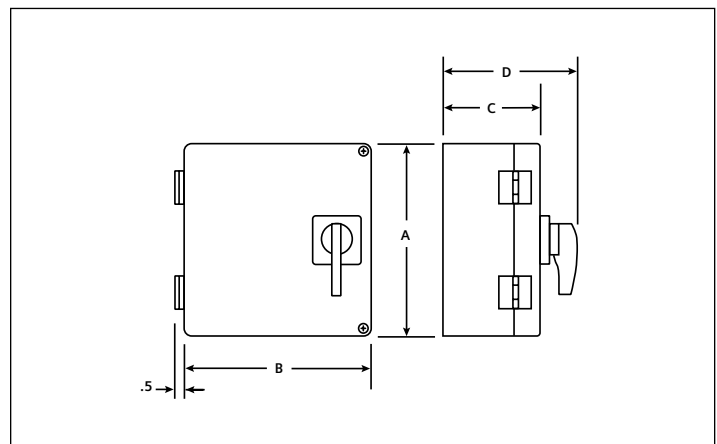

Figure 2



## UL and CUL short circuit withstand ratings

Ampere rating	Short circuit withstand rating and fuse class				
	With line side fusing			With load side fusing <sup>1)</sup>	
	10 kA at 480V max	18 kA at 480V max	10 kA at 600V max	5 kA at 480V max	18 kA at 480V max
20	H, K & RK5 (30A max)	—	—	—	—
30	H, K & RK5 (100A max)	J, T & CC (100A max)	H, K & RK5 (100A max)	H, K & RK5 (30A max)	Ferraz Shawmut A50P or lower let-through semi-conductor for fuses (60A max)
60	H, K & RK5 (150A max)		H, K & RK5 (150A max)	H, K & RK5 (60A max)	Ferraz Shawmut A50P or lower let-through semi-conductor for fuses (100A max)
100			—		

## IEC fuse and withstand ratings

Ampere rating	gG fuse size	Short circuit rating
30	63A	10k Arms
60	100A	10k Arms
100	100A	10k Arms

## Accessories

Switch ampere rating	Catalog number	Description
30-100A	<b>GSGK60</b>	Ground lug kit <sup>2)</sup>
30A	<b>LBRA1</b>	Auxiliary contact kit (1 NO - 1 NC)
60-100A	<b>LBRA2</b>	Auxiliary contact kit (1 NO - 1 NC)

<sup>1)</sup> For use as supplemental protection on the load side of the branch circuit over current protective device.

<sup>2)</sup> Ground lug kit has two lugs for #14-4 Cu/Al wire.

Siemens Industry, Inc.  
5400 Triangle Parkway  
Norcross, GA 30092

1-800-241-4453  
info.us@siemens.com

[usa.siemens.com/switches](http://usa.siemens.com/switches)

Subject to change without prior notice.  
Order No: XXXX-XXXX-XXXX  
All rights reserved.  
Printed in USA  
©2013 Siemens Industry, Inc.

The information provided in this brochure contains merely general descriptions or characteristics of performance which in case of actual use do not always apply as described or which may change as a result of further development of the products. An obligation to provide the respective characteristics shall only exist if expressly agreed in the terms of contract.

All product designations may be trademarks or product names of Siemens AG or supplier companies whose use by third parties for their own purposes could violate the rights of the owners.