

CATALOG NUMBER

EC3GB21

electricCenter

ACCESSORIES

Ground Bar Kit

21 position, #14-4 AWG

Type EC3GB



GROUND BAR INSTALLATION INSTRUCTIONS



⚠ DANGER

Hazardous Voltage.
Will cause death, serious injury
or substantial property damage.

Turn off power supplying this
equipment before working inside.



SAFETY INSTRUCTIONS

Note: This instruction outlines the recommended installation procedure. For installation by a qualified person, as defined by all local electrical codes and/or the National Electrical Code®.

Ground Bar
Mounting Dim.

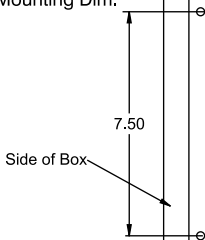

1. Turn off and lock off the power supplying the load center before working inside.
2. Mount grounding bar to back of box where holes are provided using the self-tapping screw(s) enclosed. Torque screws to 24-30 lb-in. The proper holes are located in the side wiring gutter as shown in the diagram.
3. Place enclosed "Equip. Grd." marker near the ground bar.

See wiring diagram on device for wire sizes and torques.

Siemens Industry, Inc. Norcross, Georgia U.S.A.

481000350101 Rev.XA

® The National Electrical Code is a registered trademark of the National Fire Protection Association.
© 2011 Copyright Siemens Industry, Inc. Assembled in Mexico