

**SURGE PROTECTIVE DEVICE (SPD)  
WEIGHTS & DIMENSIONS  
NEMA RATING: 1/12/3R/4**

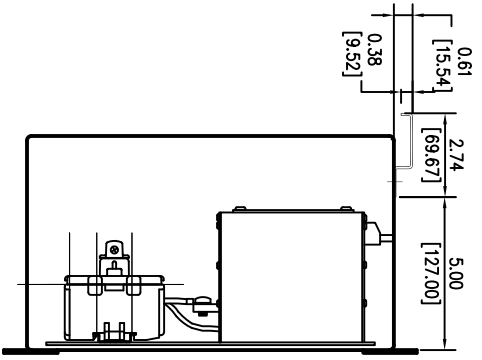
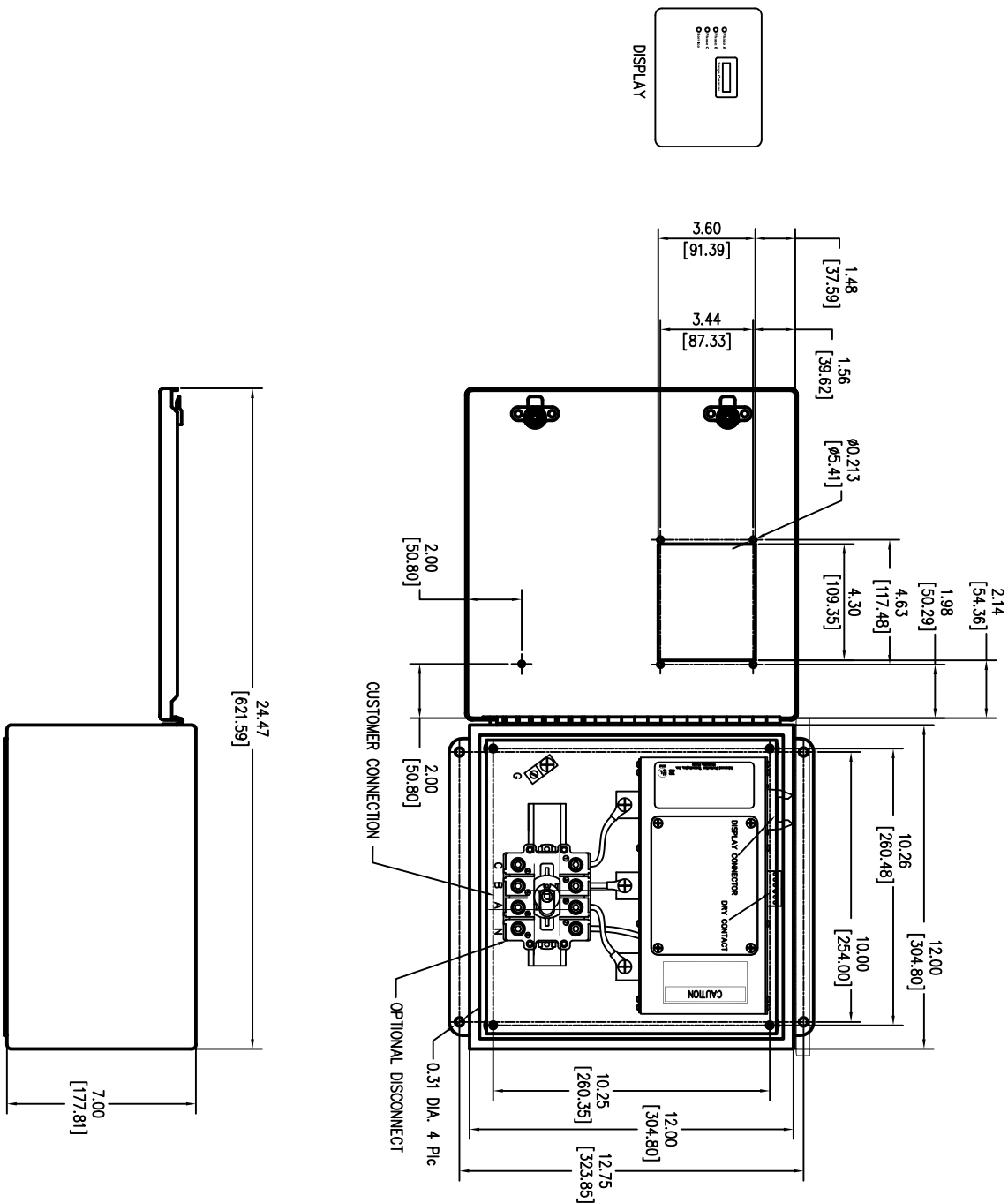

**ENCLOSURE SPECS.**  
DESC: ENCLOSURE, HINGED  
DIM: 12"H x 12"W x 7"D  
MAT: CARBON STEEL, 16 GAUGE  
FINISH: POWDERCOAT ANSI 61 GRAY  
NEMA RATING: 1/12/3R/4  
DEVICE WEIGHT: 21.70LBS. (9.84KG.)

Rev	C.N.	Date
△	-	Denotes latest changes.
□	-	Critical dimension.

DESIGNED BY: H. DRIGGERS	DATE: 6/2/26	<p>Confidential - Property of <b>Siemens Industry, Inc.</b> Building Technologies Division</p>
DRAWN BY: M.G.	DATE: 6/2/26	
CHECKED BY: M.G.	DATE: 6/2/26	
<p>TPS3-12 SERIES 100K-300K W/DS NEMA RATING: 1/12/3R/4</p>		
<p>43D-TPS3-12300DS-123RM</p>		
<p>SHEET 1 OF 1</p>		