

CATALOG NUMBER

ECGB5

electricCenter

ACCESSORIES

Ground Bar Kit 5 position, #14-4 AWG

Same As:

- GB5
- EGB5



GROUND BAR INSTALLATION INSTRUCTIONS



⚠ DANGER

Hazardous Voltage.
Will cause death, serious injury
or substantial property damage.

Turn off power supplying this
equipment before working inside.

This bag contains one ground bar, self-tapping screw(s) for mounting and one "Equip. Grd." marker.

Note: This instruction outlines the recommended installation procedure.



SAFETY INSTRUCTIONS

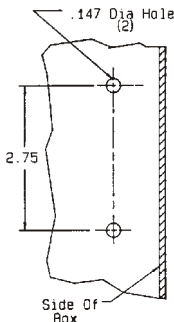

1. Turn off and lock off the power supplying the load center before working inside.

2. Mount grounding bar to back of box where holes are provided using the self-tapping screw(s) enclosed. Torque screws to 24-30 lb-in. The proper holes are located in the side wiring gutter as shown in the diagram.

3. Place "Equip. Grd." marker near the ground bar.

See wiring diagram on device for wire sizes and torques.