

LED annunciator FT2008-U1/FT2008-R1/FT2009-U1/FT2009-R1

Installation Instruction

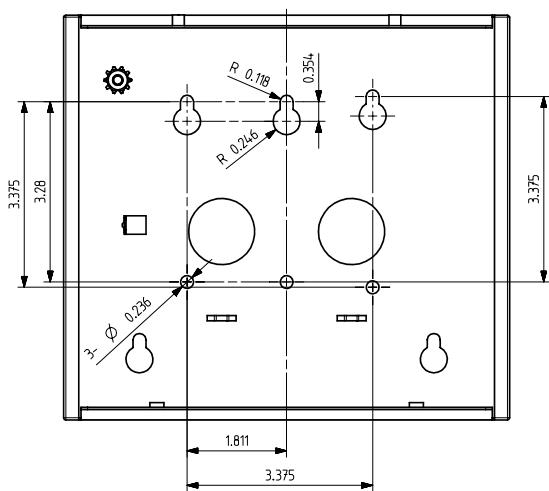

FT2008-U1/FT2008-R1

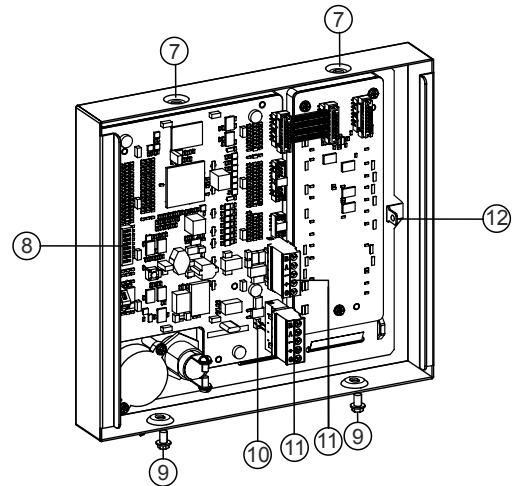
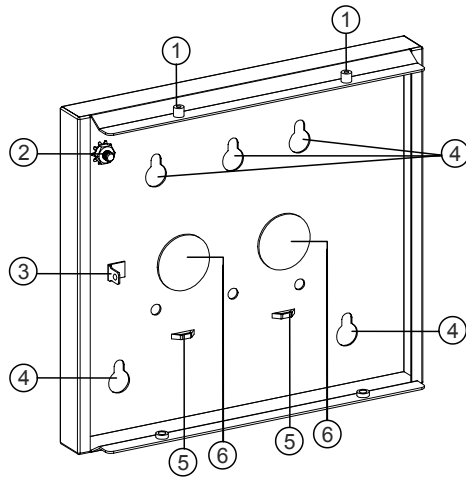
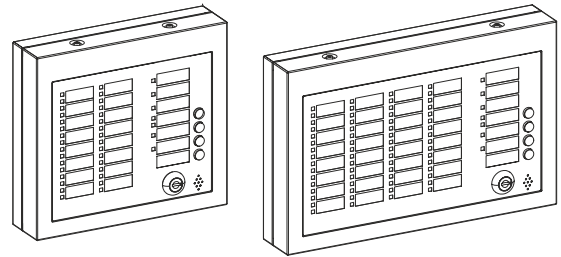
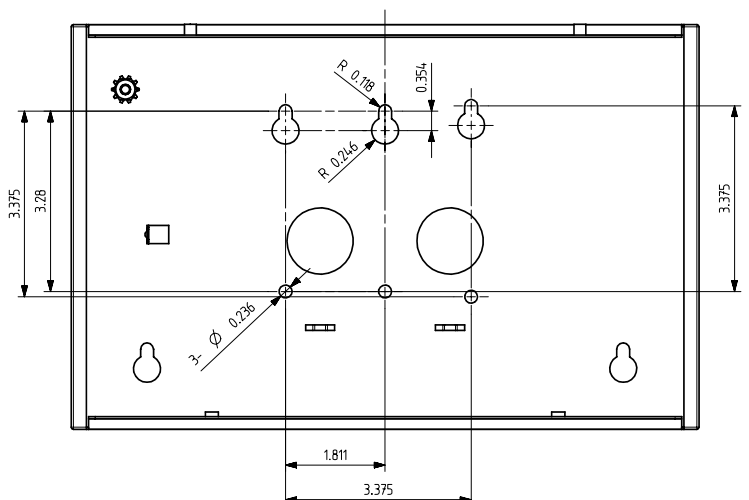

FT2009-U1/FT2009-R1

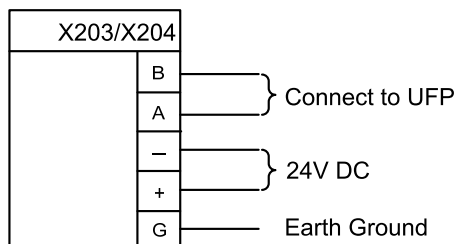

- For Canadian applications, the “FT2008-U1”/“FT2008-R1”/“FT2009-U1”/“FT2009-R1” are deemed supplementary and can be used for display only. It must be housed in a ULC-S527 approved, locked, enclosure.
- Not approved for UL/ULC MNS applications.

Intended use

The FT2008/FT2009 LED annunciator enables the fire detection system to be displayed and operated in a simplified way. The FT2008 provides 2×16 LEDs to display alarm/trouble events. The FT2009 provides 2×32 LEDs to display alarm/trouble events. Both devices are operated on the UFP line.

This device complies with Part 15 of the FCC Rules. Operation is subject to the following two conditions:
(1) This device may not cause harmful interference.
(2) This device must accept any interference received, including interference that may cause undesired operation.

Package contents

The following are included in the scope of delivery:

- FT2008-U1/FT2008-R1 or FT2009-U1/FT2009-R1
- Cable ties (2 pcs)
- EOL jumper connector (1 pcs)

Safety instructions



Risk of injury to persons and damage to property
Please observe the following safety instructions:

- The devices are only intended for stationary installation in dry rooms.
- The devices may only be connected to the UFP line.
- If panel AUX power is not used, an UL listed/recognized for fire use, regulated, power limited 24V DC power supply is required.
- Static discharge precautions should be taken when handling the FT2008/FT2009.

Legend

- 1 Stub for mounting cover (2 pcs.)
- 2 Shield terminal
- 3 Earth ground terminal
- 4 Mounting holes (8 pcs.)
- 5 Cable tie point
- 6 Breakout openings for cables (2 pcs.)
- 7 Holes for hanging front panel over stub (2 pcs.)
- 8 Dip-switch
- 9 Screws (2 pcs.)
- 10 EOL jumper
- 11 Connection terminals for UFP line and power supply
- 12 Front panel earth ground connection

Mounting instruction

1. Break out the required cable openings (6) on the backbox.
2. Mark the drilling points for the 3 mounting holes (4), drill the holes and insert the anchors (not supplied); or use the pre drilled mounting holes for installation on a 2 gang, or 4" square standard electrical box.
3. Pull the cables for the UFP and power supply, through the breakout openings (6) on the backbox.
4. Screw the backbox tightly in place.
5. Connect the cable to the terminal (11) in accordance with the connection diagram.
6. Configure Dip-switch (8) and EOL jumper (10).
7. Connect the green earth ground cable from front panel (12) to backbox (3).
8. Hook the front panel with the holes (7) over the stubs (1) on the backbox.
9. Press the front panel down over the backbox, screw (9) upwards and fix the front panel in place.

Dip-switch

8-digit Dip-switch is used for setting address and baud rate. The first 1-4 digits are for setting address, the 7-8 digits are for setting UFP communication baud rate. The 5-6 digits are reserved for future use.

Add.	Dip-switch			
	1	2	3	4
1	On	Off	Off	Off
2	Off	On	Off	Off
3	On	On	Off	Off
4	Off	Off	On	Off
5	On	Off	On	Off
6	Off	On	On	Off
7	On	On	On	Off
8	Off	Off	Off	On

Baud Rate	Dip-switch	
	7	8
9600 bps	Off	Off
19200 bps	On	Off
38400 bps	Off	On
57600 bps	On	On

Technical data

	FT2008	FT2009
Weight	2.646 lb	3.748 lb
Dimensions (W x H x D) (In: inch)	8.110x7.362 x1.949	11.417x7.362 x1.949
Storage temperature	14...140 °F	
Operating temperature	32...120.2 °F	
Humidity	≤93% rel.	
Housing	IP30	
Operating voltage	24V DC Nominal 18.8...27.2V DC	
Operating current	25 mA	25 mA
Activation current	65 mA	105 mA