

LMV2... / LMV3...

Assembly of VKF41...C gas damper with ASK33.4 mounting kit to the SQM33... actuator

User Documentation

LMV2... / LMV3... and this User Documentation are intended for use by OEMs which integrate the LMV2... / LMV3... in their products!

Supplementary documentation

Environmental Declaration LMV2... / LMV3.....	E7541
Basic Documentation LMV27.100.....	P7541
Basic Documentation LMV36.520A1 / AGM60.4A9.....	P7544
Basic Documentation LMV37.4.....	P7546
Basic Documentation LMV26... / AGM60.....	P7547
Product Range Overview LMV2... / LMV3.....	Q7541

Contents

	Supplementary documentation.....	2
1	Warning notes	4
2	Mounting.....	5

1 Warning notes

To avoid injury to persons, damage to property or the environment, the following warning notes must be observed!



All safety, warning and technical notes contained in the Basic Documentation on LMV2... / LMV3... also apply to this document!

2 Mounting

Step 1

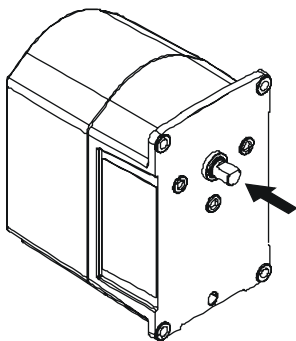

Check to ensure that the actuator's drive shaft is in the position as supplied.

This means that the flat side of the D-shaft **must** be in the 12:00 o'clock position.



Step 2

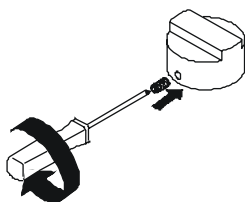

Drive the screw (M2.5) into the small threaded hole (90°) of the aluminium coupling piece ①.

Step 3

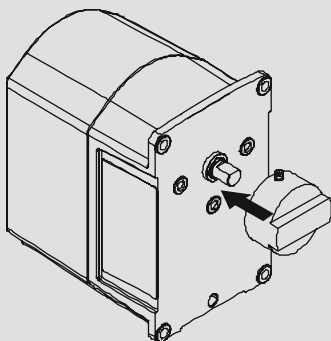

Place the aluminium coupling piece with the small threaded hole onto the D-shaft.

Turn the coupling piece ① until the rib is in the horizontal position to D-shaft.

The gap between coupling piece and actuator should be about 12 mm.

Step 4

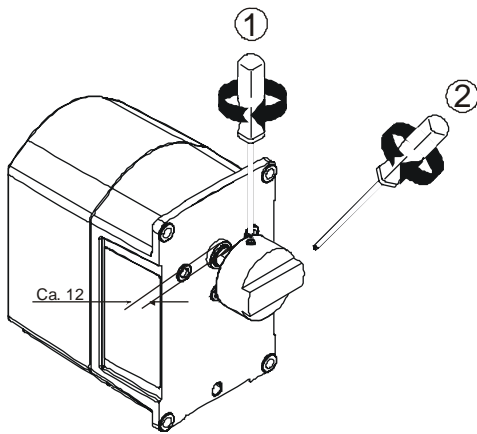

Secure the coupling piece ① to the D-shaft by tightening the screw.

Then, tighten the worm screw ② on the round side of the D-shaft.

Step 5

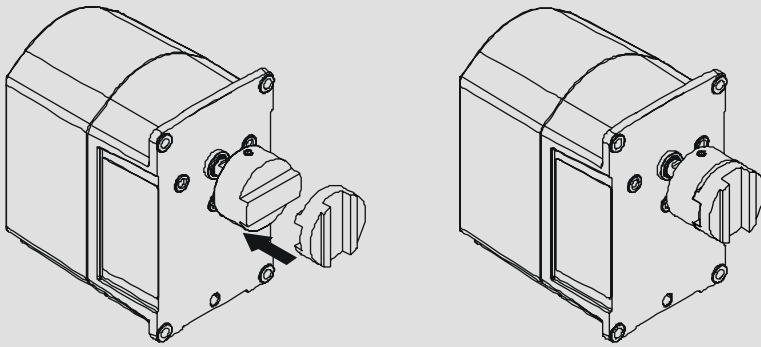

Fit the black coupling disk ②.

Step 6

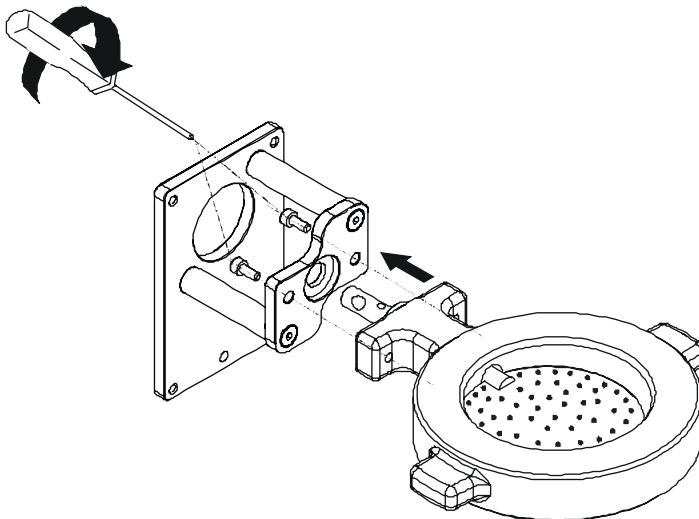

Secure the gas damper (2 x M6).

Step 7

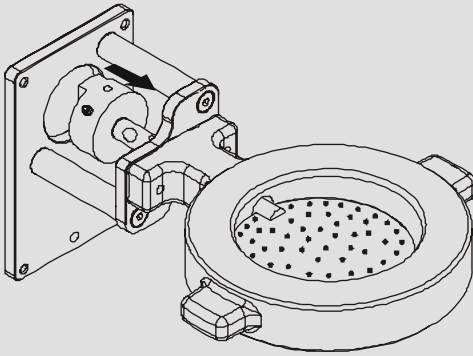

Slide the aluminium coupling piece ③ (large hole) over the gas damper's shaft.

Check to ensure that the fixing screw is positioned in the center of the fixing hole of the gas damper's shaft.

Step 8

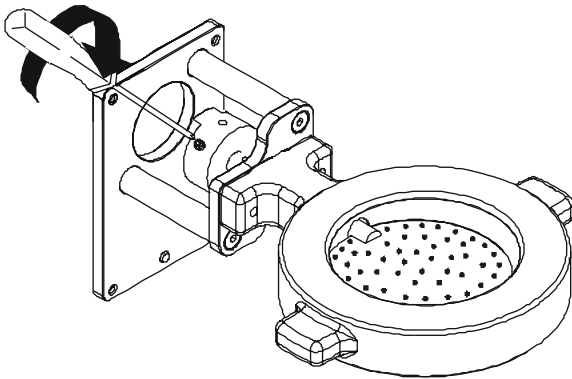

First, tighten the screw above the fixing hole.

Then, tighten the other 2 screws.

Step 9

First, make the settings on the LMV2... / LMV3...!

Note:

- Now, connect the actuator to the LMV2... / LMV3...
- Switch the system on and go to the setting mode of the LMV2... / LMV3...
- For that, enter at least the heating engineer's password

Select parameter 501 «No-flame position fuel actuator»

Index 0 = no-load position

Index 1 = prepurge position

Index 2 = postpurge position

- Set parameter 501, index 0, index 1 and index 2 from 0° to at least 9°
- Parameter 601, index 0 (reference point of fuel actuator) must be set to 1 (Siemens factory setting). This requires the OEM's password
- Parameter 602, index 0 (direction of rotation of fuel actuator) must be set to 0 (Siemens factory setting). This requires the OEM's password

Step 10

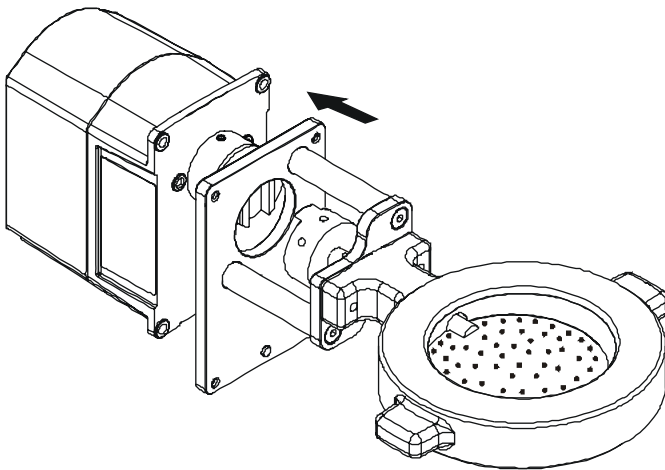

Place the plastic coupling piece ③ onto the actuator's coupling piece ②.

Assemble actuator, gas damper and mounting kit.

Step 11

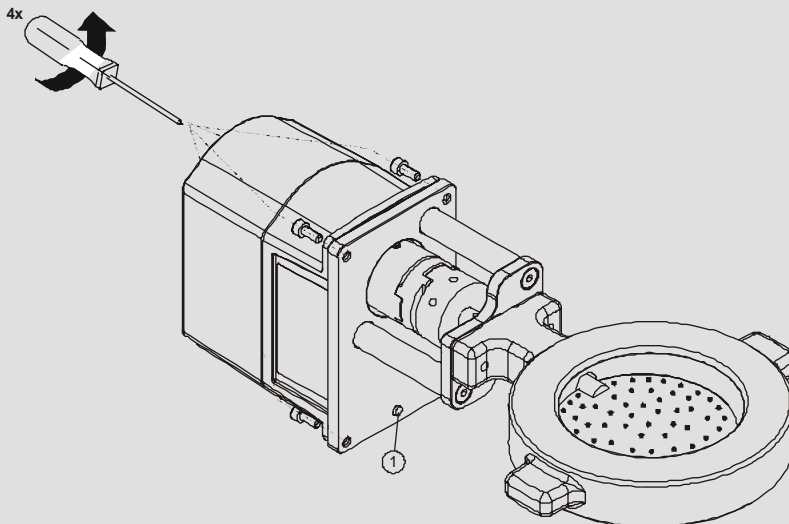

If necessary, readjust the gap between the first coupling piece and the actuator.

Secure the actuator to the mounting kit using the 4 cheese-head screws M5.

Note:

- When setting the ignition position and the fuel-air ratio curves, make certain that the position of the fuel actuator is never below 9°

① Locking pin