

QPLx5...

QPL15...

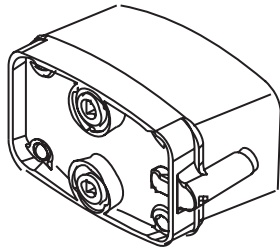

QPL25...

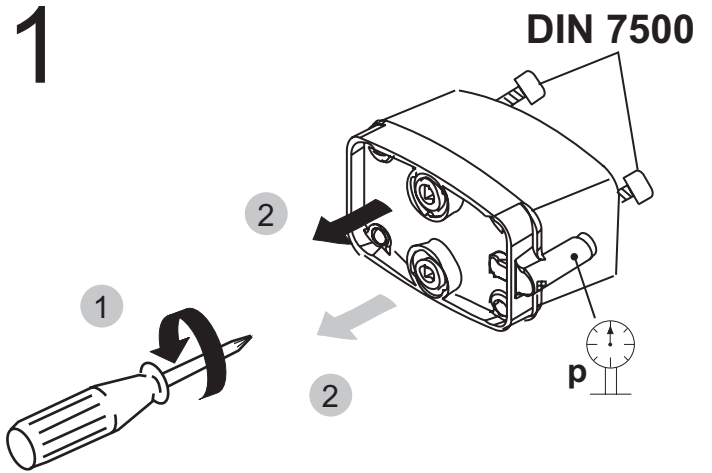
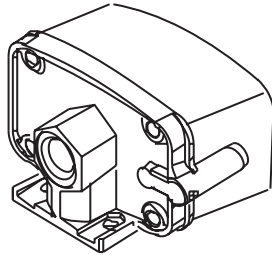

2a QPL15.../VGD2...

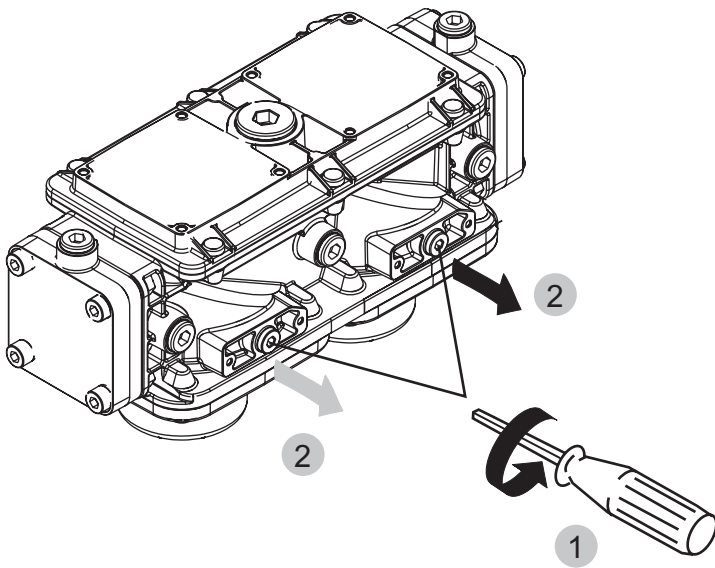

3a

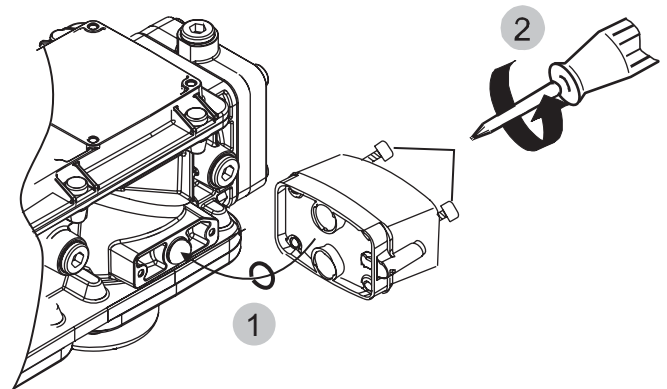

4a Anbauvarianten / Mounting variants / Variantes de montage
Beispiel / Example /Exemple

QPL15... mit O-Ring bei VGD20.4011 / VGD20.5011
 QPL15... with O-ring at VGD20.4011 / VGD10.5011
 QPL15... avec joint torique à VGD20.4011 / VGD10.5011

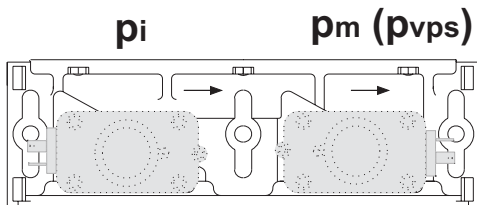

QPL25... mit Nippel Rp1/4" bei VGD20.403 / VGD20.503
 QPL25... with nipple Rp1/4" at VGD20.403 / VGD20.503
 QPL25... avec raccord de graissage à VGD20.403 / VGD20.503

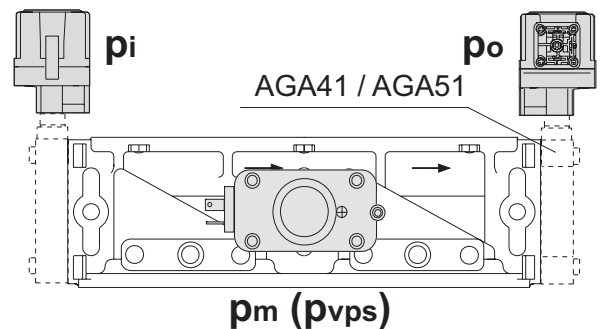

2b QPL15.../VGD4...

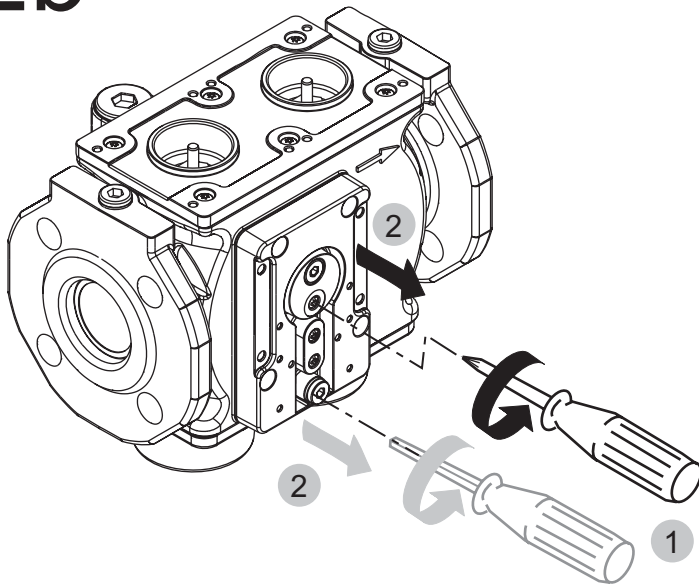

3b

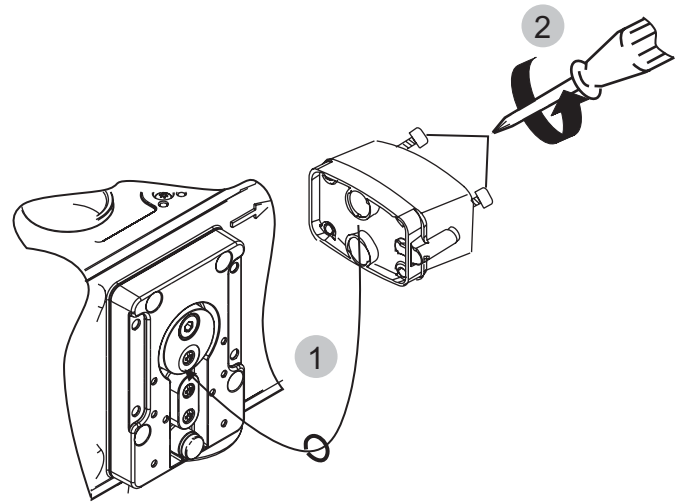

4b Beispiel / example / exemple Anbauvarianten Mounting variants Variantes de montage

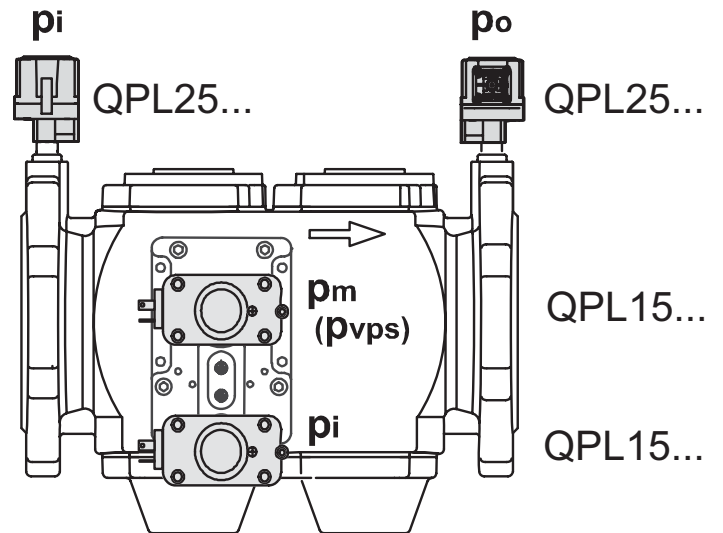

5

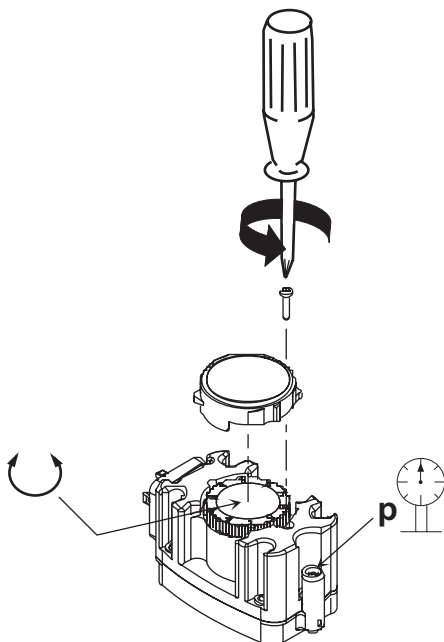

DIN EN 175301-803-A

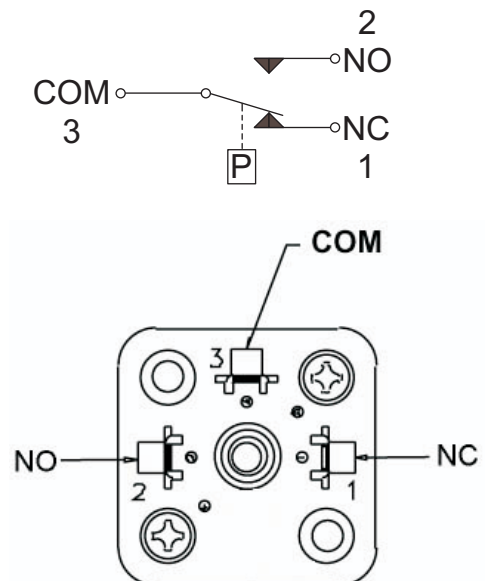

6

Druckanschlüsse / Pressure taps to / Prises de pressions

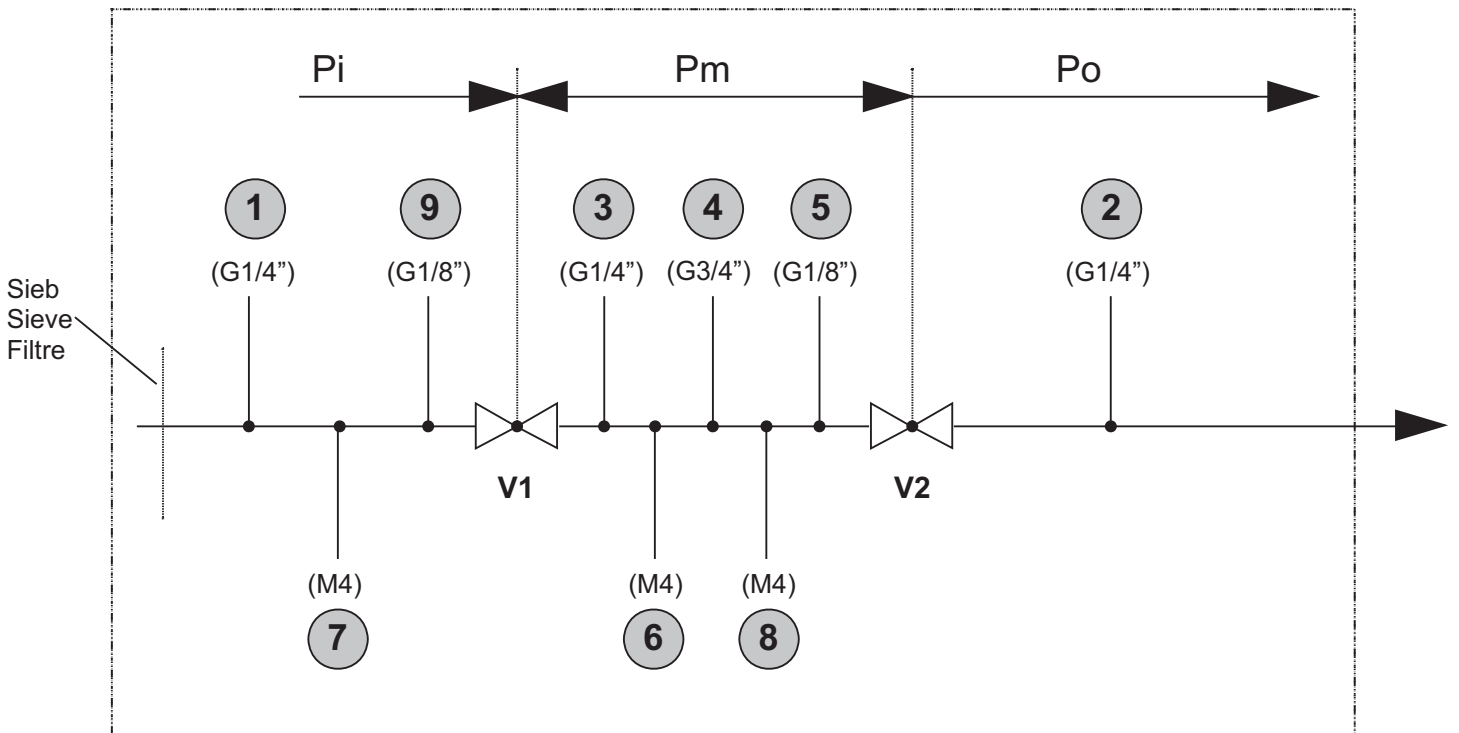
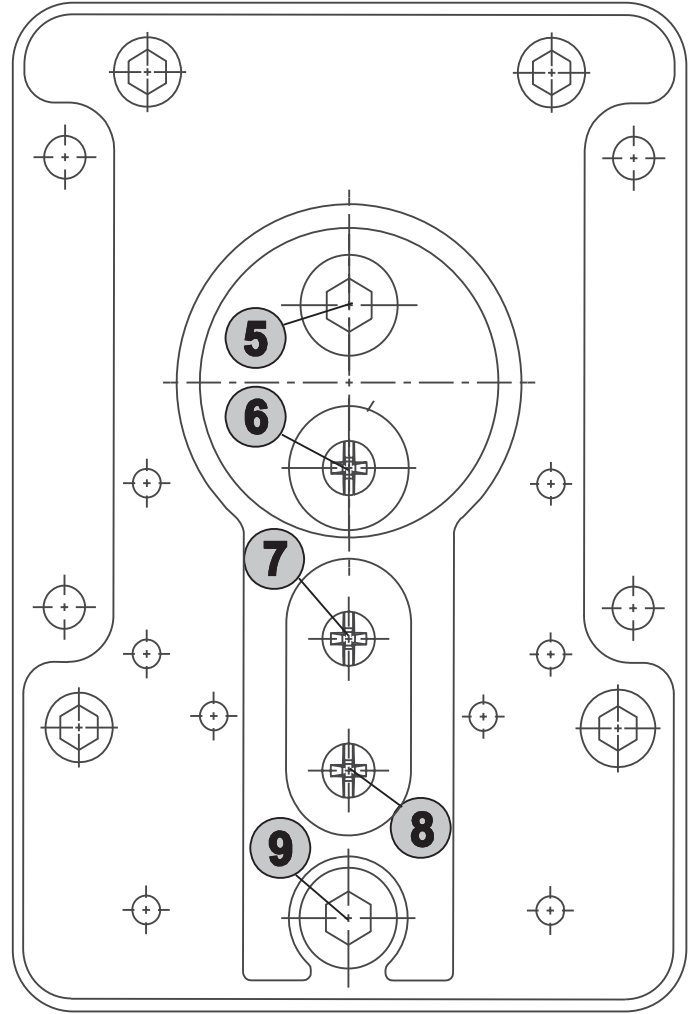
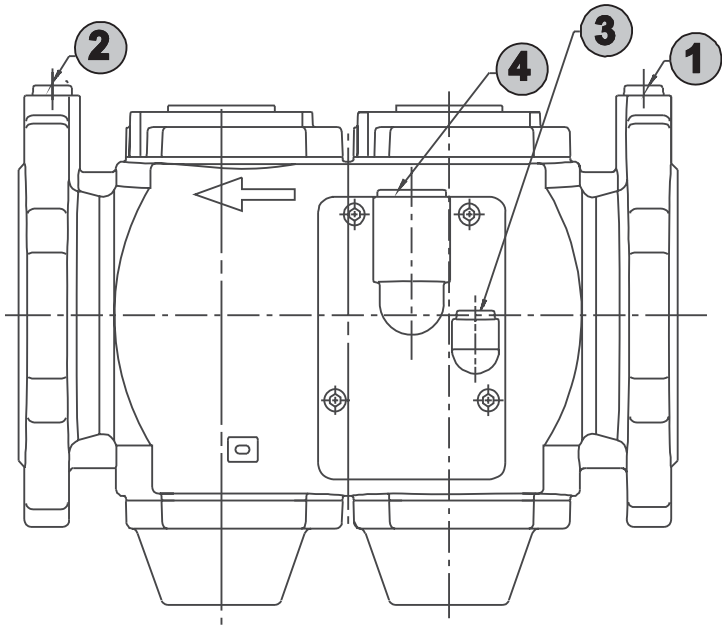

Pi = Eingangsdruck / Inlet pressure / Pression d'entrée V 1
 Pm = Druck zwischen / pressure between / Pression entre: V1/V2
 Po = Ausgangsdruck / Outlet pressure / Pression sortie V2

