



Commissioning and quick start

1. Receiver (REV-R.03/1)

Switch on power and press "RESET" button for about 4 seconds: Orange LED_2 flashes briefly. Then, press "SET" button for about 4 seconds: Orange LED_2 flashes slowly; learning mode is active.

Within 25 minutes press "ESC" button on REV23.03RF for about 4 seconds: Orange LED_2 flashes fast and briefly; LED_1 changes from red to flashing green.

After commissioning, the unit will operate automatically.

2. Transmitter (REV23.03RF)

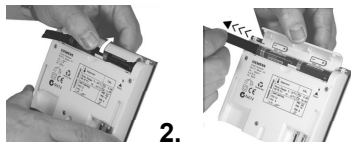

1. Remove controller from its base and open cover of the battery compartment.
2. Remove the black battery transit tab. The controller will switch itself on.
3. Close the battery compartment and replace the controller.

Selecting the operating mode



The operating mode selector enables you to select 5 different operating modes:

- Automatic operation with a maximum of 3 heating / cooling periods
- Continuously comfort mode
- Continuously economy mode
- Continuously frost protection mode
- 24-hour mode with 1 comfort period

Changing temporarily the current setpoint temperature

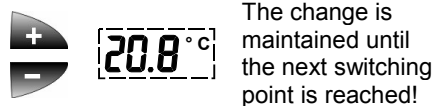

The change is maintained until the next switching point is reached!

1. When pressing the or button for the first time, the currently valid setpoint temperature will be displayed. It can be readjusted in increments of 0.2 °C (max. +/-4 °C).
2. After a short time, the initial display will automatically appear again.

Changing temporarily the temperature setpoint (savings tip)

In operating modes **Auto** and , this button can be pressed to make a manual change from comfort to economy mode, or vice versa. The change will automatically be cancelled when reaching the next switching point or when selecting another operating mode.

(Press button approximately for 4 seconds to transmit test telegrams.)

Symbole			24-hour mode		2 heating periods
	"Time" menu		Heating active		Comfort setpoint
	"Temperature" menu		Cooling active		Economy setpoint
	"Heating periods" menu		Automatic operation		Setpoint frost protection
	"Absence" menu		Continuously comfort mode		Absence setpoint
	Battery change		Continuously economy mode		Not used with this unit
	Absence		Frost protection		1 heating period

Functions of the roller selector

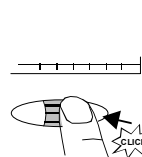

Press:

- You access the menu level
- You activate the menu
- You save the inputs
- You switch to the next menu item
- You accept the menu item

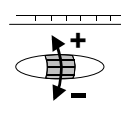

Roll:

- You go from one menu to the next
- You change the setting variables (temperature in increments of 0.2 °C, time in increments of hours and minutes)
- You select predefined functions

Escape button

Press the Esc button to return to the menu level previously activated or to leave the menu level in a number of steps until you reach the initial display (the settings currently displayed will be accepted).

(Press button approximately for 4 seconds to transmit learning telegram.)



Setting the time of day and the weekday

- Adjustable in operating modes **Auto**, , and

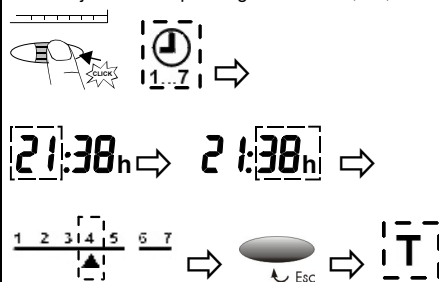

1. Press: You access the menu level; the **clock** flashes.
2. Press: You accept the menu; the **hours** flash.
3. Roll: Set the current **hour**.
4. Press: You save the input; the **minutes** flash.
5. Roll: Set the current **minute**.
6. Press: You save the input; the **weekday** flashes.
7. Roll: Select the current **weekday**.
8. Press the Esc button to return to the menu level: the **T** menu flashes.

If no button is pressed for a short time, the setting displayed will be accepted and the initial display will appear again.

Changing temperatures long-term

- Adjustable in operating modes **Auto**, , and

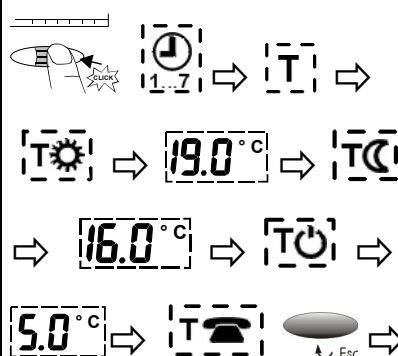

1. Press: You access the menu level; the **clock** flashes.
2. Roll: Toward the display to the **T** menu.
3. Press: You accept the menu; symbol **T** flashes.
4. Press: You accept **T** ; the **setpoint** flashes.
5. Roll: Set the **comfort temperature**
6. Press: You save the input; symbol **TC** flashes.
7. Press: You accept **TC** ; the **setpoint** flashes.
8. Roll: Set the **economy temperature**.
9. Press: You save the input; symbol **TO** flashes.
10. Press: You accept **TO** ; the **setpoint** flashes.
11. Roll: Set the **frost protection temperature**.
12. Press: You save the input, symbol **T** flashes. **Adjustment not required; not used with this unit.**
13. Press the Esc button to return to the menu level: The heating periods menu flashes. (Change not necessarily required; press the Esc button again to return to the initial display.)

If no button is pressed for a short time, the setting displayed will be accepted and the initial display will appear again.

Settings for automatic operation with 2 heating periods

- Adjustable in operating modes **Auto**, and

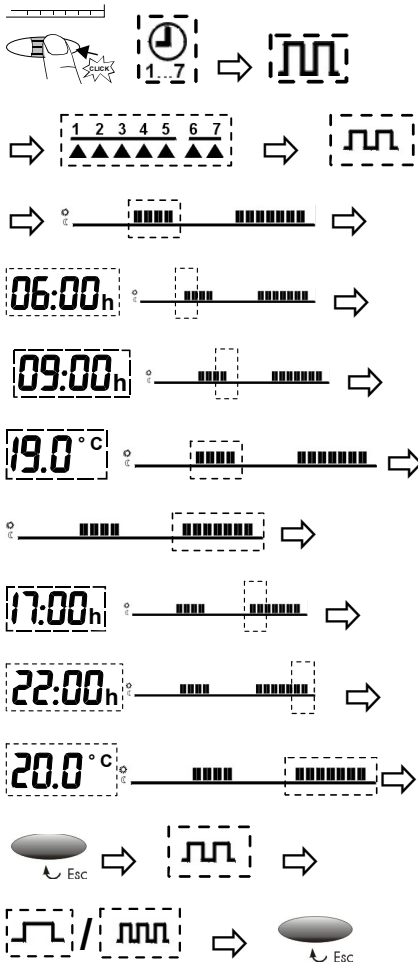

If no button is pressed for a short time, the setting displayed will be accepted and the initial display restored.

- Press: You access the menu level; the **clock** flashes.
- Roll: Twice toward the display; menu flashes.
- Press: You accept the menu; the **day selection** symbol flashes.
- Roll: Select the days, the working days, the weekend or the week.
- Press: You accept the selection made; **heating period** flashes.
- Press: Accept ; **heating period 1** flashes.
- Press: You accept **heating period 1**; **start time** of heating period 1 flashes.
- Roll: Set the **start time** of heating period 1.
- Press: You save the input; **end time** of heating period 1 flashes.
- Roll: Set the **end time** of heating period 1.
- Press: You save the input; **setpoint** of heating period 1 flashes.
- Roll: Set the **setpoint** of heating period 1.
- Press: You save the input; **heating period 2** flashes.
- Press: You accept **heating period 2**; **start time** of heating period 2 flashes.
- Roll: Set the **start time** of heating period 2.
- Press: You save the input; **end time** of heating period 2 flashes.
- Roll: Set the **end time** of heating period 2.
- Press: You save the input; **setpoint** of heating period 2 flashes.
- Roll: Set the **setpoint** of heating period 2.
- Press the Esc button to return to the **heating periods** menu: Menu item **heating periods** flashes.
- Roll: Toward the display or away from it to menu item or heating periods

(Change not necessarily required; press the Esc button several times to leave the menu level in several steps, thus returning to the initial display.)

Settings for automatic operation with 1 or 3 heating periods

- Adjustable in operating modes **Auto**, and

The procedure to be followed is the same as that for automatic operation with 2 heating periods the only difference being that, in addition, a setpoint for heating period 3 can be entered (standard setting 21 °C).

Absence / holidays

- Adjustable in operating modes **Auto**, and

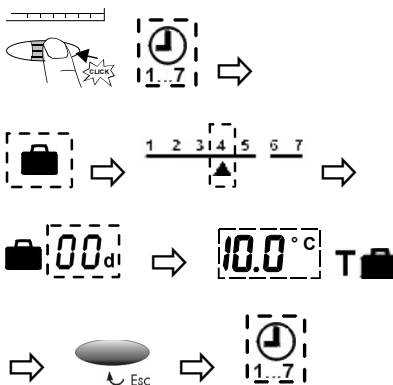

If no button is pressed for a short time, the setting displayed will be accepted and the initial display will appear again.

- Press: You access the menu level; the **clock** flashes.
- Roll: Away from the display; menu flashes.
- Press: Accept ; symbol flashes.
- Roll: Set the start (weekday) of your absence.
- Press: You save the input; **the number of days** flash.
- Roll: Set the duration of your absence; **number of days** (max. 99)
- Press: You save the input; setpoint **T** flashes.
- Roll: Set the temperature.
- Press the Esc button to return to the menu level; the **clock** flashes. (Change not necessarily required; press the Esc button again to return to the initial display.)

Remote operation (for reason of mobility, there is no connection facility)

- Adjustable in operating modes **Auto**, and

Setpoint **T** can be adjusted, but is not used with this unit.

24-hour operation

- Adjustable in operating mode

24-hour mode with one comfort period only.

Start of comfort period, end of comfort period and temperature setpoint can be set individually by roller selector.

Retrieving the default values

Press the button behind the small opening for at least one second, thus resetting the user-specific settings to their default values (the heating engineer settings will remain unchanged).

The clock starts at 12:00.

When making a reset, all display fields will light up.

Default values

Factory settings for heating

Operating mode			
Start of continuous operation	00:00	00:00	00:00
End of continuous operations	24:00	24:00	24:00
Setpoint of comfort mode	19 °C		
Setpoint of economy mode		16 °C	
Setpoint frost protection			5 °C
Setpoint T absence	12 °C		
Operating mode	Auto		
Selected periods			
Start of period 1	07:00	06:00	06:00
End of period 1	23:00	08:00	08:00
Start of period 2		17:00	11:00
End of period 2		22:00	13:00
Start of period 3			17:00
End of period 3			22:00
Setpoint of period 1	19 °C	19 °C	19 °C
Setpoint of period 2		20 °C	20 °C
Setpoint of period 3			21 °C
Setpoint T absence	12 °C		

Default values

Factory settings for cooling

Operating mode	Auto			
Setpoint	23 °C	23 °C	29 °C	35 °C
Setpoint T absence	30 °C			

Changing the batteries 2 Alkaline batteries type AA 1.5 V

When this symbol appears, the batteries must be replaced within 3 months.

- Remove controller from its base.
- Open battery compartment at the rear and replace the batteries.
- Close battery compartment and replace the controller.

Caution:

When changing the batteries, the current data are maintained for a maximum of one minute.