

- de** Montageanleitung
- en** Mounting instructions
- fr** Instructions de montage
- sv** Monteringsinstruktion
- nl** Montage-handleiding
- it** Istruzioni di montaggio
- fi** Asennusohje
- es** Instrucciones de montaje
- da** Monteringsvejledning
- pl** Instrukcja montażu
- cz** Montážní návod
- hu** Szerelési útmutató
- el** Οδηγίες εγκατάστασης
- ru** Инструкция по установке
- zh** 安裝指導

- Hilfsschalter
- Auxiliary switch
- Contact auxiliaire
- Hjälkontakt
- Hulpschake-laar
- Contacto ausiliario
- Apukytkin
- Contacto auxiliar
- Hjælpe-kontakt
- Przełącznik pomocniczy
- Pomocný kontakt
- Segédkap-csoló
- Βοηθητικός διακόπτης
- Вспомогательный выключатель
- 辅助开关



ASC1.6



SKB62 + ASC1.6 + ~~ASZ62.6~~
SKC62

1



4568Z06

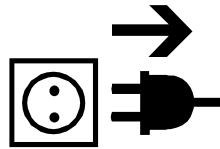

+

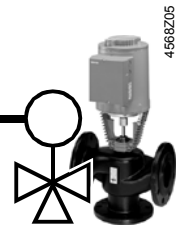

4568Z05

SKB60, SKB62..., SKC60, SKC62...

SKD60, SKD62...

2

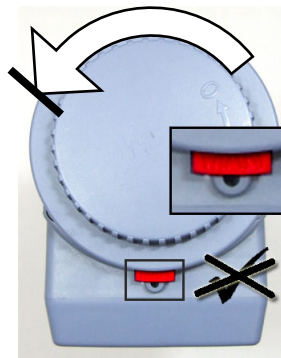
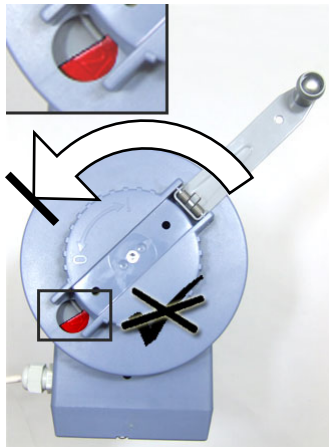

3



4

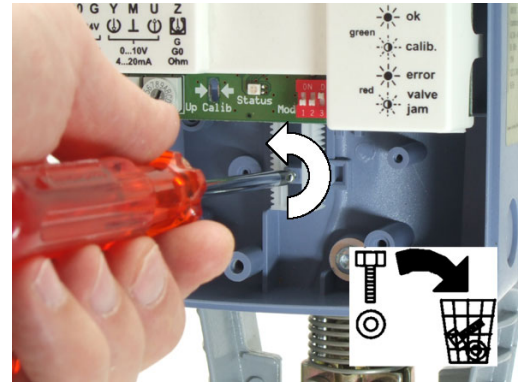

5

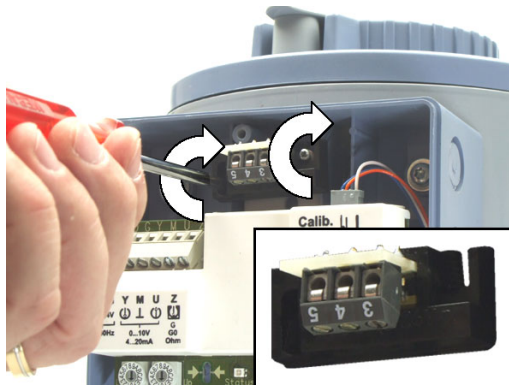

de leicht anziehen
 en tighten slightly
 fr serrer sans forcer
 sv dra åt lätt
 nl licht aandraaien
 it fissare leggermente
 fi kiristä kevyesti
 es apretar suavemente
 da spændes let til
 pl dokreć lekko
 cz lehce utáhnout
 hu finoman meghúzni
 el σφίξτε με δύναμη
 zh 轻微地锁紧

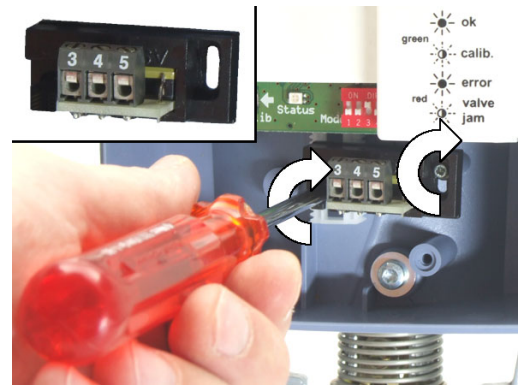

6

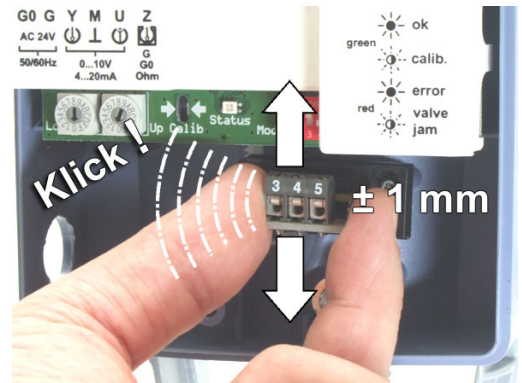
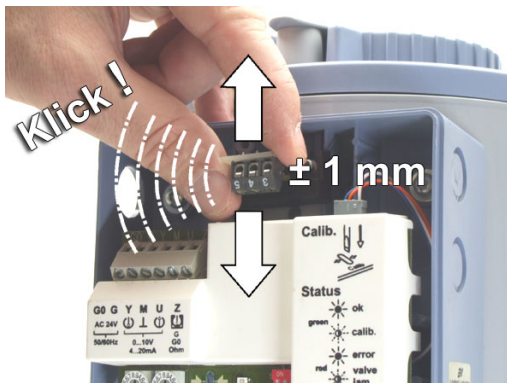

7

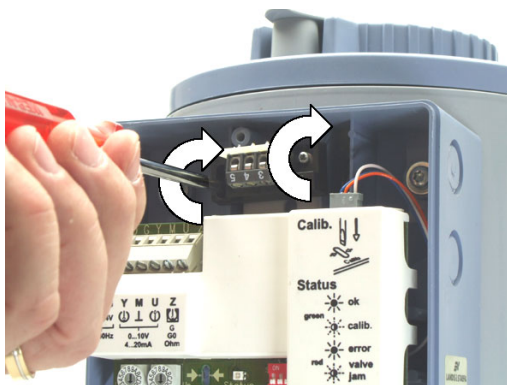

de festziehen
 en tighten
 fr serrer à fond
 sv dra fast
 nl vastschroeven
 it fissare
 fi kiristä
 es atomillar
 da skrue fastgøres
 pl dokreść
 cz utáhněte
 hu erősen meghúzni
 el σφίξτε
 zh 锁紧

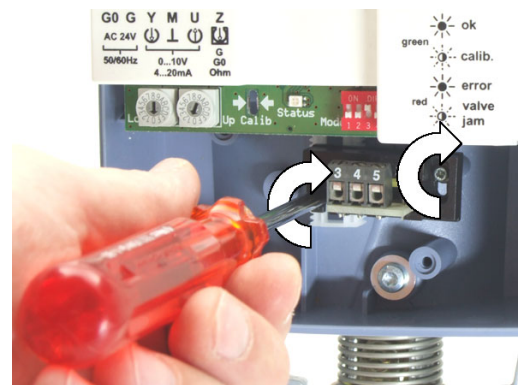

8

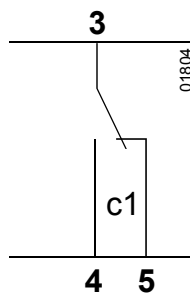

c1: ASC1.6

AC 24 V
 10 mA ... 4 A resistive
 max. 2 A inductive

9

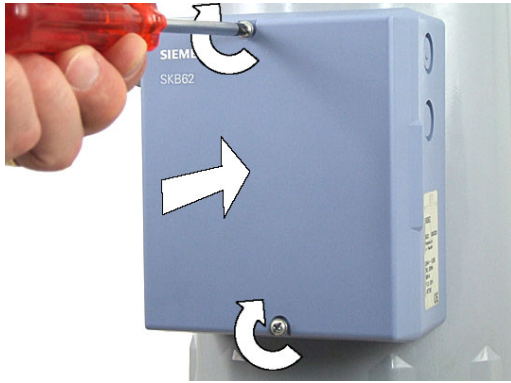

10



- de **Montageanleitung**
- en **Mounting instructions**
- fr **Instructions de montage**
- sv **Monteringsinstruktion**
- nl **Montage-handleiding**
- it **Istruzioni di montaggio**
- fi **Asennusohje**
- es **Instrucciones de montaje**
- da **Monteringsvejledning**
- pl **Instrukcja montażu**
- cz **Montážní návod**
- hu **Szerelési útmutató**
- el **Οδηγίες εγκατάστασης**
- ru **Инструкция по установке**
- zh **安裝指導**

**SKB60, SKB62...
SKC60, SKC62...**

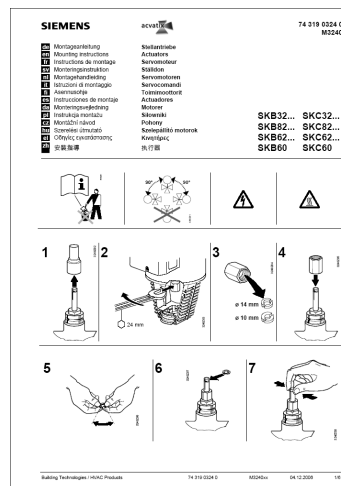

74 319 0324 0

SKD60, SKD62...

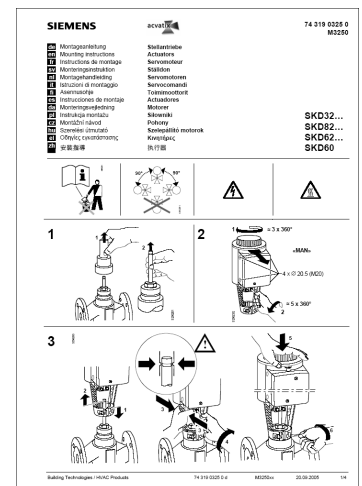

74 319 0325 0

